

# SHAWNEE

## hillside

SH



- ↑ Longhouse; 7 one-room units
- ⌚ Located on Main Street near Point tennis courts
- ♿ Units 4 & 5: bathroom with tub/shower combo

- ✚ Porch
- 🚫 No fire pits
- ♿ Units 1, 2, 3, 6, & 7 are handicap accessible with a walk in shower

## Beds & Capacity by Unit

**Units 2, 4, & 6:** 2 twin beds can be converted to a king bed upon prior notice.

	Unit #	1	2	3	4	5	6	7
Beds	Twin		2		2		2	
	Bunk							
	Double							
	Queen	1		1		1		1
	King							
Capacity	Minimum	NA	2	NA	2	NA	2	NA
	Normal	2	2	2	2	2	2	2
	Maximum	3	3	3	3	3	3	3

## Summer 2024 Pricing

**Units 1, 3, 5, & 7:** Contact Registrar for single occupancy rates.  
**Units 2, 4, & 6:** No single occupancy.

	Week	Adult	7 - 13 yr old	1 - 6 yr old
<b>21,22</b>	Weeks 1, 8, & 9	\$836.50	\$423.50	\$70.00
	Weeks 2, 3, & 7	\$899.50	\$462.00	\$80.50
	Weeks 4, 5, & 6	\$927.50	\$479.50	\$87.50

# SHAWNEE

Each unit is approximately 298 square feet

Units 1, 3 & 7

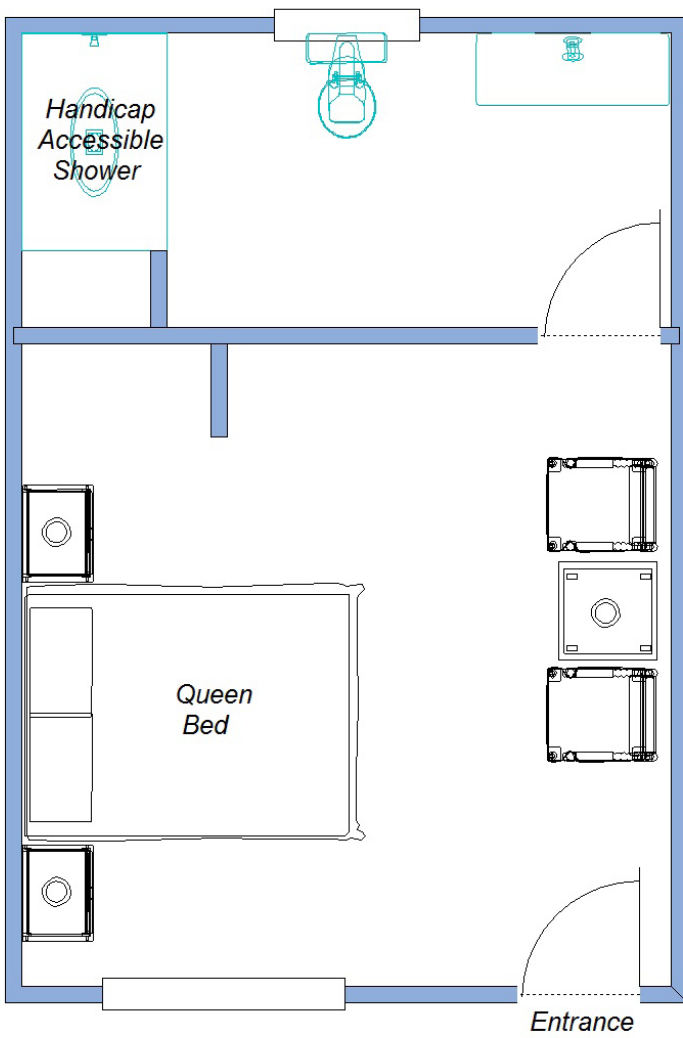

Units 2 & 6

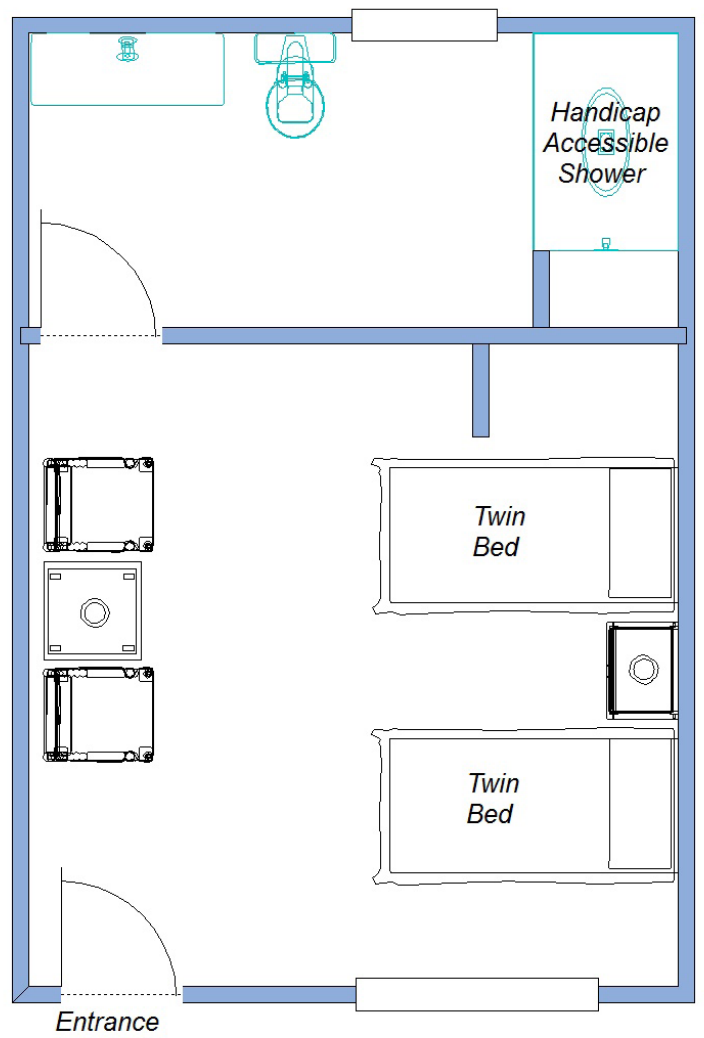

# SHAWNEE

Each unit is approximately 298 square feet

Unit 4

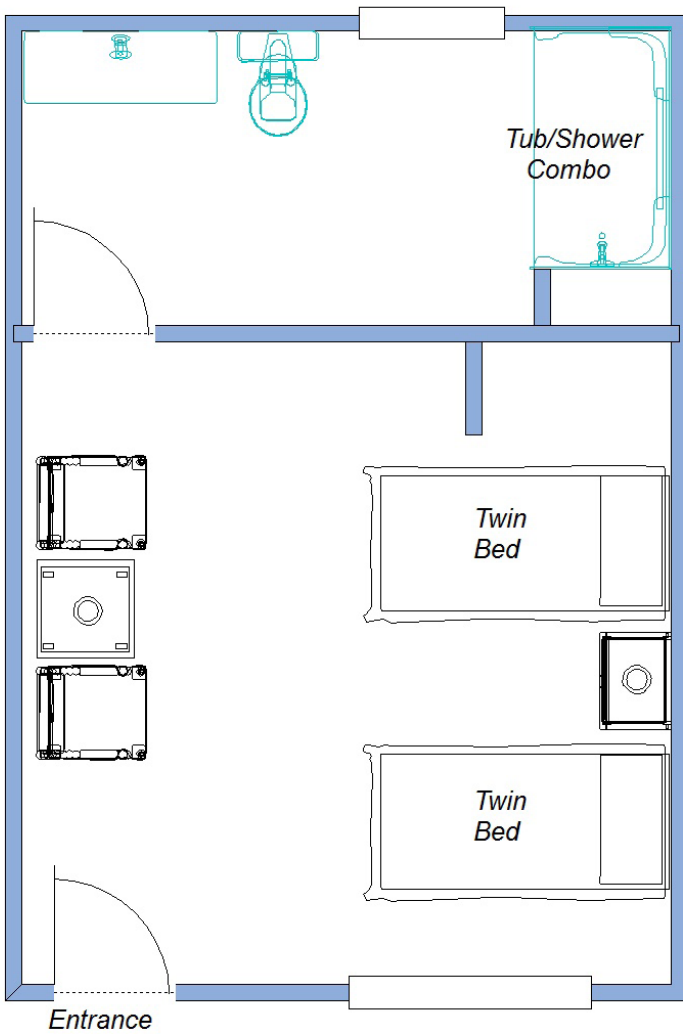

Unit 5

