

# CHICKASAW

CH

beachfront



🏠 Longhouse; 4 one-room units

📍 Located just off the beach between Oneida and Onondaga

♿ Units 1 & 2: Walk in shower  
Units 3 & 4: Tub/shower combo

✚ Porch, and mini fridge

🚫 No firepits

♿ Units 1 & 2 are handicap accessible and have a handicap accessible shower (wheelchair ramp next to unit 1)

## Beds & Capacity by Unit

**Unit 3:** King bed can be converted to 2 twin beds upon prior notice.

	Unit #	1	2	3	4
Beds	Twin				
	Bunk				
	Double				
	Queen	1	1		1
	King			1	
Capacity	Minimum	NA	NA	NA	NA
	Normal	2	2	2	2
	Maximum	2	2	2	2

## Summer 2024 Pricing

Week	Adult	7 - 13 yr old	1 - 6 yr old
Weeks 1, 8, & 9	\$1,067.50	\$493.50	\$101.50
Weeks 2, 3, & 7	\$1,144.50	\$532.00	\$108.50
Weeks 4, 5, & 6	\$1,186.50	\$560.00	\$115.50

# CHICKASAW

Approximately 234 square feet

Unit 1

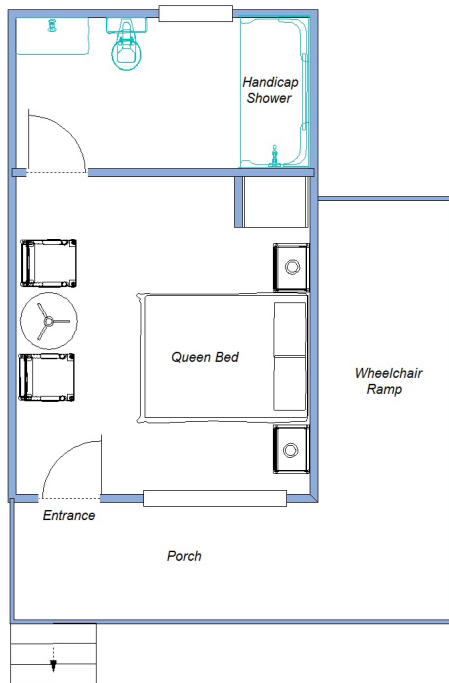

Unit 2

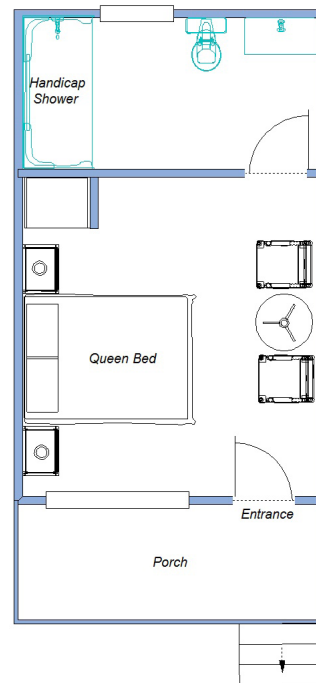

Unit 3

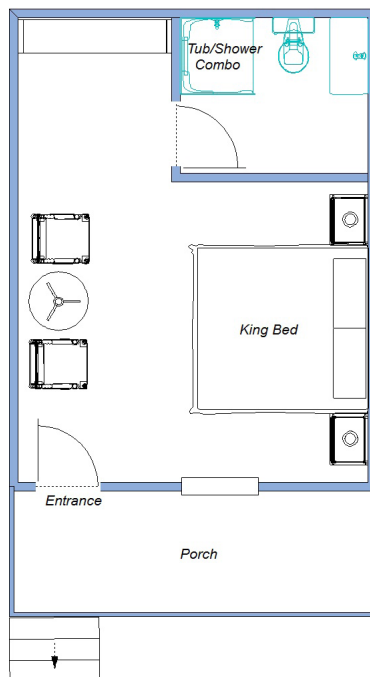

Unit 4

