

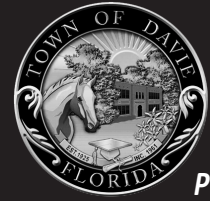

**Craven Thompson
& Associates, Inc.**
Project Management
Engineering
Landscape Architecture
Surveying & Planning

3563 NW 53rd Street, Fort Lauderdale, FL 33309
Phone: (954) 739-6400

PREPARED FOR



PDF FORMAT



TFA

C

REQUEST FOR PROPOSAL • RFP # B-17-28

**CONSTRUCTION ENGINEERING AND INSPECTION SERVICES
FOR DAVIE ROAD PHASE II • LOCAL AGENCY PROGRAM (LAP)**

DECEMBER 28TH, 2016

TAB A



CRAVEN THOMPSON & ASSOCIATES, INC.
Engineers • Planners • Surveyors • Landscape Architects

TOWN OF DAVIE
CONSTRUCTION ENGINEERING AND INSPECTION SERVICES
FOR DAVIE RD PHASE II – LOCAL AGENCY PROGRAM (LAP)

RFQ NO. B-17-28

Proposero:

Craven Thompson & Associates, Inc.
3563 NW 53rd Street
Fort Lauderdale, Florida 33309
Phone: (954) 739-6400
Contact: Patrick J. Gibney, P.E.
Vice President, Engineering

December 28, 2016

TAB B



TAB B - TABLE OF CONTENTS

TOWN OF DAVIE - REQUEST FOR QUALIFICATIONS NO. B-17-28

TAB	CONTENTS	PAGE NO.
A.	TITLE PAGE	A
	▪ Title Page.....	A-1
B	TABLE OF CONTENTS.....	B
	▪ Table of Contents	B-1
C	LETTER OF INTEREST	C
	▪ Letter of Interest	C-1
D	PROJECT TEAM FORM	D
	▪ Project Team Form	D-1
E	ORGANIZATIONAL CHART.....	E
	▪ Management Plan.....	E-1
	▪ Organizational Chart.....	E-2
F	STATEMENT OF SKILLS AND EXPERIENCE OF PROJECT TEAM	F
	▪ Statement of kills and Experience of Project Team.....	F-1
	▪ Craven Thompson - FDOT Qualification Letter	F-4
	▪ Marlin Engineering - FDOT Qualification Letter / OSD MBE Certification.....	F-5
	▪ Progressive Design - FDOT Qualification Letter / DBE Certification.....	F-8
G	RESUMES OF KEY PERSONNEL	G
	▪ Resumes of Key Personnel.....	G-1
H	REFERENCES.....	H
	▪ Craven Thompson & Associates - 3 LAP Projects (FDOT 10.1).....	H-1
	▪ Marlin Engineering - LAP Project (FDOT 10.4).....	H-4
	▪ Craven Thompson & Associates - Prior Projects for Town of Davie	H-5
I	OFFICE LOCATIONS.....	I
	▪ Office Locations.....	I-1
J	REQUIRED FORMS / MISCELLANEOUS	J
	▪ Required Proposal Submittal Form	J-1
	▪ Non-Collusive Affidavit	J-2
	▪ E-Verify Form.....	J-3
	▪ Confirmation of Drug-Free Workplace	J-4
	▪ Employee Background Verification Affidavit.....	J-5
	▪ Town of Davie - Vendor/Bidder Disclosure.....	J-6
	▪ Town of Davie - Local Vendor Preference	J-8
	▪ Local Vendor Preference - Broward County Vendor.....	J-9



CRAVEN-THOMPSON & ASSOCIATES, INC.
Engineers • Planners • Surveyors • Landscape Architects

TAB B - TABLE OF CONTENTS

TOWN OF DAVIE - REQUEST FOR QUALIFICATIONS NO. B-17-28

- Form W-9 J-10
- Lobbying Interest J-11
- Lobbying Interest J-12
- Town of Davie Lobbyist Registration Statement.....J-13
- Lobbyist’s Principal(s) Information J-14
- Acknowledgement of Addenda J-15
 - Addendum No. 1 J-16
 - Addendum No. 2.....J-17
 - Addendum No. 3..... J-19
- Proposal Signature Page for CorporationJ-20
- Proposal Signature Page for Partnership.....J-21
- Solicitation, Giving, and Acceptance of Gifts Policy J-22
- Source of Information J-23
- Indemnification Clause J-24
- Public Entity Crimes Form J-25
- Anti-Kickback Affidavit J-27
- Proposer Questionnaire J-28
- Truth in negotiation Certification J-32
- Conflict of Interest Certification for Consultant / Contractor J-33
- Certification Regarding Debarment, Suspension, Ineligibility and Voluntary Exclusion for Federal Aid ContractsJ-34
- Certification for Disclosure of Lobbying Activities on Federal Aid Contracts.....J-35
- Professional Licenses / Corporate CharterJ-36
- Insurance CertificationJ-39
- LitigationJ-40
- Broward County - Business Tax Receipt..... J-41

TAB C



CRAVEN THOMPSON & ASSOCIATES, INC.
Engineers • Planners • Surveyors • Landscape Architects

December 28, 2016

Town of Davie
Procurement Division
Attn: Mr. Brian K. O'Connor, C.P.M.
6591 Orange Drive
Davie, Florida 33314

RE: CONSTRUCTION ENGINEERING AND INSPECTION SERVICES FOR DAVIE RD PHASE II – LOCAL AGENCY PROGRAM, RFQ NO. B-17-28

Dear Mr. O'Connor and Selection Committee:

In response to **The Town of Davie's** Request for Qualifications from qualified firms for construction engineering inspection services for Davie Road Phase II, **Craven Thompson and Associates, Inc.** (CTA) - primary firm responding, FDOT Pre-qualification 10.1)), sub-consultant Marlin Engineering, Inc. (FDOT Pre-qualification 10.4), and Progressive Design and Engineering, Inc. (FDOT DBE Certified) are pleased to submit this Statement of Qualifications for your consideration. The CTA Team will provide all tasks specified within the Scope of Services. We have provided similar services requested in your RFP on many past.

Complete Corporate Name of Primary Firm Responding & Federal Tax ID Number

Craven Thompson & Associates, Inc.
Federal Tax ID No. 59-0948029

Primary contact, office location, email, and phone number:

Patrick J. Gibney, P.E., Vice President, Engineering
Project Manager / Client Contact
Craven Thompson & Associates, Inc.
3563 NW 53rd Street
Fort Lauderdale, FL 33309
Phone: (954) 739-6400
Fax: (954) 739-6409
Email: pgibney@craventhompson.com

We understand the services under this RFQ to consist of Construction Engineering Inspection (CEI), all Local Agency Program (LAP) processes, procedures and documentation submittals required for successful completion of the project, any coordination with Federal Highway Administration (FHWA), and liaison with all applicable governmental permitting and certifying governmental agencies based on plans designed and permitted by Calvin Giordano & Associates, Inc.

The improvements are to re-construct a public roadway known as Davie Road within public Right-of-Way owned by Broward County extending from the SW 39th Street to Nova Drive. The length of the reconstruction is approximately 4,705 linear feet generally consisting of pavement, base and sub-



Craven-Thompson & Associates, Inc.
Engineers • Planners • Surveyors • Landscape Architects

grade reconstruction, curb & gutter construction, bike lane construction, sidewalk construction, median construction, driveway reconstruction within Right-of-Way, minor drainage system construction, landscaping & irrigation construction, pavement marking & signage, traffic signal modification at SW 39th Street and SW 37th Street, street lighting, and coordination with franchise utility companies.

In addition to providing standard CEI services, the CTA Team shall obtain access to FDOT LAP reporting documentation systems: Local Area Program Information Tool (LAPIT) and Equal Opportunity Compliance (EOC), conduct and submit labor interviews for conformance with wage rates and DBE monitoring reports, prepare and submit monthly LAP progress report(s), upload contract documents, payment applications, change orders, and related documents, prepare, coordinate and submit (for FDOT approval) construction changes orders, schedule and conduct a final inspection with FDOT LAP representatives, assist the Town with preparation and submittal of FDOT LAP close-out package ('Blue Folder'), coordinate and assist the Town with reimbursement package submittal, and conduct periodic landscape inspections as deemed applicable for LAP approval.

CTA commits to the Town of Davie that our team as identified in the organizational chart will be available to complete the Davie Road Phase II Construction Engineering Services within the Town's designated schedule.

We sincerely appreciate the opportunity of providing this Statement of Qualifications to the Town of Davie and would welcome the chance to further demonstrate our capabilities to you and your staff.

Sincerely,

Craven Thompson & Associates, Inc.

PATRICK J. GIBNEY, P.E.
Vice President, Engineering

PJG/tg

TAB D

Town of Davie
CEI For Davie Road Phase II Roadway Improvement Project (LAP)

PROJECT TEAM FORM

PRIME

Role	Name of Individual Assigned to Project	Number of Years Experience	Education, Degrees
Principal-In-Charge	<u>Patrick J. Gibney, P.E.</u>	<u>30 Years</u>	<u>BS - Civil Engineering</u>
Project Manager	<u>Don Shaver, Construction Manager</u>	<u>35 Years</u>	<u>BS - Const. Science</u>
Asst. Project Manager	<u>Marc Woodworth, Const. Inspection</u>	<u>20 Years</u>	<u>BS-Civil & Environmental</u>
Other Key Member	<u>Brian Tull, Construction Inspection</u>	<u>19 Years</u>	<u>N/A</u>
Other Key Member	<u>Joseph Handley, RLA, Landscape CEI</u>	<u>33 Years</u>	<u>BS - Ornamental Horticulture</u>

SUB-CONSULTANT

Role	Company Name and Address of Office Handling This Project	Name of Individual Assigned to the Project
Signalization & Lighting CEI Services (FDOT DBE)	<u>Progressive Design & Engineering</u> <u>20283 SR 7, #300, Boca Raton, FL 33498</u>	<u>Wael Majdalawi, P.E., P.T.O.E.</u>
Landscaping	<u>N/A</u>	<u>_____</u>
Engineering	<u>N/A</u>	<u>_____</u>
Other Key Member (CEI - FDOT 10.4)	<u>Marlin Engineering, Inc.</u> <u>1700 SW 66 Ave., #106, Plantation, FL 33313</u>	<u>James Spinks, P.E., P.T.O.E.</u>
Other Key Member	<u>_____</u>	<u>_____</u>
Other Key Member	<u>_____</u>	<u>_____</u>

(use attachments if necessary)

TAB E



CRAVEN • THOMPSON & ASSOCIATES, INC.
Engineers • Planners • Surveyors • Landscape Architects

TAB E - ORGANIZATIONAL CHART

TOWN OF DAVIE - REQUEST FOR QUALIFICATIONS NO. B-17-28

MANAGEMENT PLAN

Mr. Patrick J. Gibney, P.E. will be the client contact and consultant project manager for the Davie Road Phase II construction engineering services project. Mr. Gibney will liaison with the Town Engineer, the Town LAP Compliance Officer and the design Engineer of Record (EOR).

Reporting immediately to Mr. Gibney will be Craven Thompson & Associates, Inc. (CTA) Construction Manager, Don Shaver. Both Mr. Gibney and Mr. Shaver served in the same capacities for the CEI services for the Davie Road Phase I construction. Mr. Shaver will coordinate day-to-day inspection duties of the inspectors for CTA on the roadway (FDOT prequalified 10.1), CTA landscape, Marlin Engineering (FDOT prequalified 10.4), and PDE. CTA and PDE will utilize the same inspectors for this project as were used for the CEI services for the construction of Davie Road Phase I.





CRAVEN-THOMPSON & ASSOCIATES INC.
Engineers - Planners - Surveyors - Landscape Architects

RFQ # B-17-28

TOWN OF DAVIE - CONSTRUCTION
ENGINEERING AND INSPECTION
SERVICES FOR DAVIE ROAD PHASE II
- LOCAL AGENCY PROGRAM (LAP)



CRAVEN-THOMPSON
& ASSOCIATES INC.

Principal-in-Charge (10.1)
Patrick Gibney, P.E.

CRAVEN-THOMPSON
& ASSOCIATES INC.

Construction Manager
(10.1)
Don Shaver

CRAVEN-THOMPSON
& ASSOCIATES INC.

Landscape CEI
Joseph D. Handley, R.L.A.

CRAVEN-THOMPSON
& ASSOCIATES INC.

Construction Inspection
(10.1)
Marc Woodworth, E.I.
Brian Tull

MARLIN

Minor Bridge &
Miscellaneous Structure CEI
(10.4)
James Spinks, P.E., P.T.O.E.

P&E Progressive Design
& Engineering, Inc.

Traffic Signal CEI
Wael Majdalawi P.E., P.T.O.E.
Gary Robeson, P.E.

TAB F



CRAVEN THOMPSON & ASSOCIATES, INC.
Engineers • Planners • Surveyors • Landscape Architects

TAB F - STATEMENT OF SKILLS AND EXPERIENCE OF PROJECT TEAM

TOWN OF DAVIE - REQUEST FOR QUALIFICATIONS NO. B-17-28

STATEMENT OF SKILLS AND EXPERIENCE OF PROJECT TEAM

Craven Thompson & Associates, Inc. (CTA) has been involved in Local Agency Program (LAP) projects since 2009. Our personnel have worked extensively as Resident Compliance Specialist for Local Agency Program (LAP) projects for the City of Aventura. These projects include Yacht Club Way Bridge, Country Club Drive Exercise Path Improvements, Biscayne Boulevard Lighting Project, and the Transit Bus Stop Project. Duties included coordinating with General Contractors on required forms such as weekly certified payrolls, checking of payroll to prevailing wage tables, monthly reporting to Florida Department of Transportation (FDOT), gathering of required EEO/Affirmative Action reports and policies, review of application for payments to the City and preparation of Reimbursement Requests to FDOT.



In the mid 2000's CTA was the prime consultant for the South County Neighborhood Improvement Project - Phase V for Broward County. LAP funding included landscaping and sidewalk improvements. CTA managed the construction contract administration and FDOT interface for Broward County on the project.

Patrick J. Gibney, P.E. was the Project Manager for three LAP funded projects for the City of Oakland Park, which ran from 2011 through 2015 (including design through construction). These three projects were known as the NE 38th Street, NW 38th Street and NW 34th Court complete Streets Projects.



The NE 38th Street Project involved landscape, hardscape, and streetscape enhancement, a complete storm sewer system, a roundabout to replace an existing traffic signal, traffic calming devices, utility coordination and relocation, and full roadway reconstruction. The main project objective was to discourage truck traffic and redirect cut-through traffic from NE 38th Street to alternate routes between Andrews Avenue and NE 11th Avenue. This project required permit



CRAVEN • THOMPSON & ASSOCIATES, INC.
Engineers • Planners • Surveyors • Landscape Architects

TAB F - STATEMENT OF SKILLS AND EXPERIENCE OF PROJECT TEAM

TOWN OF DAVIE - REQUEST FOR QUALIFICATIONS NO. B-17-28

approvals from Broward County Environmental Protection and Growth Management Department (BCEPGMD), and the City of Oakland Park Public Works and Engineering and Community Development Departments.

The NW 38th Street Project involved landscape, hardscape, and streetscape enhancement, traffic calming devices, utility coordination and relocation, and full roadway reconstruction. The main Project objective was to complete the NE / NW 38th Street Project from Federal Highway to Royal Palm Park. This project required permit approvals from Broward County Environmental Protection and Growth Management Department (BCEPGMD), and the City of Oakland Park Public Works and Engineering and Community



The NE 34th Court Project included full roadway reconstruction design, stormwater management ICPR modeling and design, utility coordination and relocation, landscape and streetscape enhancement, and all associated jurisdictional permitting. This project required permit approvals from Broward County Environmental Protection and Growth Management Department (BCEPGMD), Broward County Health Department, and the City of Oakland Park Public Works and Engineering and Community Development Departments.





CRAVEN • THOMPSON & ASSOCIATES, INC.
Engineers • Planners • Surveyors • Landscape Architects

TAB F - STATEMENT OF SKILLS AND EXPERIENCE OF PROJECT TEAM

TOWN OF DAVIE - REQUEST FOR QUALIFICATIONS NO. B-17-28

Mr. Gibney and Don Shaver (Director of Construction Management) were involved in the LAP project known as the Resurfacing and ADA Sidewalk Improvement Project in the City of Miami Gardens which was completed in 2014. This project included approximately 24,000 linear feet of road throughout the city in three neighborhoods. The neighborhoods consist of a mixture of single and multi-family residential dwellings. Significant amounts of the existing roadway infrastructure within these neighborhoods did not meet current ADA requirements, which warranted attention in order to conform to current standards. In order to address the infrastructure needs, the City of Miami Gardens selected CTA to analyze the roadway corridors within the project areas to determine necessary resurfacing and ADA improvements. CTA prepared plans for the resurfacing of all roads after having borings prepared to analyze the existing roadway conditions. Concurrently, the area was reviewed for sidewalk and ADA improvements to ensure compliance with ADA standards. The project involved coordination with FDOT for LAP funding and design criteria, and the development of construction drawings and specifications.

The Sistrunk Boulevard Streetscape and Enhancement Project, completed in December of 2012, is another example of CTA's experience with LAP projects. Don Shaver and Brian Tull (Construction Inspector) were both involved in this project. CTA represented the City of Fort Lauderdale as the Resident Project Representative. While the design of this project was managed by the City's Community Redevelopment Agency (CRA), the construction portion was administered by the City of Fort Lauderdale's Public Works Department. Primary funding for construction

was provided by the Fort Lauderdale CRA. The project area encompasses 2.5 miles of Sistrunk Boulevard (NE / NW 6th Street), from Federal Highway to NW 24th Avenue, and included streetscape and infrastructure improvements which consisted of landscaped medians, paver sidewalks, decorative street lighting, traffic signal mast arm installations, undergrounding of overhead utilities, drainage improvements, new water mains and the relocation of various sanitary sewer lines. Construction cost was approximately 14 million dollars. Work included on-site resolution of construction conflicts and design changes, construction inspection services for quality control and project certification, coordination with FPL, AT&T and Comcast for utility conversions from overhead to underground, close coordination with existing businesses during construction, public relations to keep all parties informed of the ongoing improvements, maintenance of traffic coordination to ensure continuous access to all affected properties, monthly Pay Application reviews, Change Order reviews and various other construction management duties.





Florida Department of Transportation

RICK SCOTT GOVERNOR

605 Suwannee Street Tallahassee, FL 32399-0450

JIM BOXOLD SECRETARY

April 25, 2016

Thomas McDonald, President CRAVEN, THOMPSON & ASSOCIATES, INC. 3563 NW 53rd Street Fort Lauderdale, Florida 33309

Dear Mr. McDonald:

The Florida Department of Transportation has reviewed your application for qualification package and determined that the data submitted is adequate to technically qualify your firm for the following types of work:

- Group 3 - Highway Design - Roadway
3.1 - Minor Highway Design
3.2 - Major Highway Design
Group 10 - Construction Engineering Inspection
10.1 - Roadway Construction Engineering Inspection
Group 15 - Landscape Architect

Your overhead audit has been accepted, enabling your firm to compete for Professional Services projects advertised at the unlimited level, with estimated fees of any dollar amount. This status shall be valid until June 30, 2017 for contracting purposes.

Table with 5 columns: Overhead Rate, Home/Branch Office, Facilities Capital Cost of Money, Overtime Premium Reimbursed, Direct Expense. Values: 161.83%, 0.055%, Reimbursed, 0.70% (Home)

Should you have any questions, please feel free to contact me by email at carliayn.kell@dot.state.fl.us or by phone at 850-414-4597.

Sincerely,

Handwritten signature of Carliayn Kell

Carliayn Kell Professional Services Qualification Administrator



Florida Department of Transportation

**RICK SCOTT
GOVERNOR**

605 Suwannee Street
Tallahassee, FL 32399-0450

**JIM BOXOLD
SECRETARY**

July 18, 2016

Ramon Soria, PE, President
MARLIN ENGINEERING, INC.
1700 NW 66th Avenue, Suite 106
Plantation, Florida 33313

Dear Mr. Soria:

The Florida Department of Transportation has reviewed your application for qualification package and determined that the data submitted is adequate to technically qualify your firm for the following types of work:

Group 2 - Project Development and Environmental (PD&E) Studies

Group 3 - Highway Design - Roadway

- 3.1 - Minor Highway Design
- 3.2 - Major Highway Design
- 3.3 - Controlled Access Highway Design

Group 5 - Bridge Inspection

- 5.1 - Conventional Bridge Inspection
- 5.2 - Movable Bridge Inspection
- 5.3 - Complex Bridge Inspection
- 5.4 - Bridge Load Rating

Group 6 - Traffic Engineering and Operations Studies

- 6.1 - Traffic Engineering Studies
- 6.2 - Traffic Signal Timing

Group 7 - Traffic Operations Design

- 7.1 - Signing, Pavement Marking and Channelization
- 7.2 - Lighting
- 7.3 - Signalization

Group 8 - Survey and Mapping

- 8.1 - Control Surveying
- 8.2 - Design, Right of Way & Construction Surveying

- Group 10 - Construction Engineering Inspection
 - 10.1 - Roadway Construction Engineering Inspection
 - 10.3 - Construction Materials Inspection
 - 10.4 - Minor Bridge & Miscellaneous Structures CEI

- Group 13 - Planning
 - 13.3 - Policy Planning
 - 13.4 - Systems Planning
 - 13.5 - Subarea/Corridor Planning
 - 13.6 - Land Planning/Engineering
 - 13.7 - Transportation Statistics

Your overhead audit has been accepted, enabling your firm to compete for Professional Services projects advertised at the unlimited level, with estimated fees of any dollar amount. This status shall be valid until June 30, 2017 for contracting purposes.

	Home/Branch <u>Office</u>	Field <u>Office</u>	Facilities Capital Cost <u>of Money</u>	Overtime <u>Premium</u> Reimbursed	<u>Direct Expense</u>
Overhead Rate	155.27%	133.52%	0.227%		3.51% (Home) 11.39% (Field)*

*Rent and utilities excluded from field office rate. These costs will be directly reimbursed on contracts that require the consultant to provide field office.

Should you have any questions, please feel free to contact me by email at carliayn.kell@dot.state.fl.us or by phone at 850-414-4597.

Sincerely,

Carliayn Kell
Professional Services
Qualification Administrator

State of Florida

Minority, Women & Florida Veteran Business Certification

Marlin Engineering, Inc.

Is certified under the provisions of
287 and 295.187, Florida Statutes, for a period from:

04/03/2015 to 04/03/2017



Chad Poppell, Secretary
Florida Department of Management Services



Florida Department of Transportation

RICK SCOTT
GOVERNOR

605 Suwannee Street
Tallahassee, FL 32399-0450

JIM BOXOLD
SECRETARY

May 23, 2016

Karen Majdalawi, President
PROGRESSIVE DESIGN & ENGINEERING, INC.
10891 La Reina Road, Suite 100
Delray Beach, Florida 33446

Dear Ms. Majdalawi:

The Florida Department of Transportation has reviewed your application for qualification package and determined that the data submitted is adequate to technically qualify your firm for the following types of work:

- Group 3 - Highway Design - Roadway
 - 3.1 - Minor Highway Design
 - 3.2 - Major Highway Design

- Group 6 - Traffic Engineering and Operations Studies
 - 6.1 - Traffic Engineering Studies
 - 6.2 - Traffic Signal Timing
 - 6.3.1 - Intelligent Transportation Systems Analysis and Design
 - 6.3.2 - Intelligent Transportation Systems Implementation

- Group 7 - Traffic Operations Design
 - 7.1 - Signing, Pavement Marking and Channelization
 - 7.2 - Lighting
 - 7.3 - Signalization

- Group 10 - Construction Engineering Inspection
 - 10.1 - Roadway Construction Engineering Inspection

Your firm is now technically qualified to pursue work for the Department for minor projects only, enabling your firm to compete for Professional Services projects with fees estimated at below \$500,000.00. This status shall be valid until May 23, 2017 for contracting purposes.

On the basis of self-certification materials submitted, the rates listed below represent the costs the Department has accepted.

	Home/Branch	Overtime
	<u>Office</u>	<u>Premium</u>
Indirect Cost	148.87%	Excluded

Should you have any questions, please feel free to contact me by email at carliayn.kell@dot.state.fl.us or by phone at 850-414-4597.

Sincerely,



Carliayn Kell
Professional Services
Qualification Administrator

CBHK/kw



Florida Department of Transportation

CHARLIE CRIST
GOVERNOR

605 Suwannee Street
Tallahassee, FL 32399-0450

STEPHANIE C. KOPELOUSOS
SECRETARY

November 9, 2007

Certified Mail – Return Receipt Requested

Progressive Design & Engineering, Inc.
Ms. Karen Majdalawi
10891 La Reina Rd, Ste 100
Delray Beach FL 33446

ANIVERSARY DATE- Annually on August 19

Dear Ms. Majdalawi:

The Florida Department of Transportation [FDOT] is pleased to announce that your firm is certified under the **Florida Unified Certification Program [UCP]** as a **Disadvantaged Business Enterprise [DBE]** in accordance with Part 49 Section 26, Code of Federal Regulations.

DBE certification is continuing, but is contingent upon the firm maintaining its eligibility annually through this office. You will be notified of your annual responsibilities in advance of the **Anniversary Date**. You must submit the annual **AFFIDAVIT FOR CONTINUING ELIGIBILITY** no later than the **Anniversary Date**. Failure to do so will result in immediate action to decertify the firm.

Only those firms listed in the UCP DBE Directory, are certified by Florida UCP Members. **Prime contractors and consultants should verify your firms DBE certification status, and identify the only work area(s) for which the firm is DBE eligible, through this Directory.**

Your firm will be listed in Florida's UCP DBE Directory which can be accessed via the internet, at <http://www.bipincwebapps.com/biznetflorida/> or through The Department' website at www.dot.state.fl.us/equalopportunityoffice, then select "DBE Directory."

DBE certification is **NOT** a/ guarantee of work, but enables the firm to compete for, and perform, contract work on all USDOT Federal Aid (FAA, FTA and FHWA) projects in Florida is a DBE contractor, sub-contractor, consultant, sub-consultant or material supplier.

If, at any time, there is a material change in the firm, including, but not limited to, ownership, officers, Directors, scope of work being performed, daily operations, affiliations with other businesses or individuals or physical location of the firm, you must notify this office, in writing, within (30) days. Notification should include supporting documentation. You will receive timely instruction from this office as to how you should proceed, if necessary.

Your firm is eligible to compete for, and perform, work on all USDOT Federal Aid projects throughout Florida, and may earn DBE credit for work performed in the following areas:

NAICS:	FDOT Specialty Code & Description
541690	300-Other Scientific and Technical Consulting Services
541330	941-Civil Engineering Services
541330	942-Electrical Engineering Services
541340	947-CADD Services
541690	949-Traffic Data Services

Questions or concerns should be directed to this office by mail or telephone. Our telephone number is (850) 414-4747. Our Fax number is (850) 414-4879.

Sincerely,

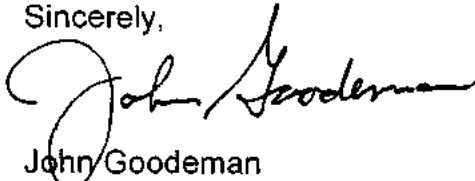

John Goodman
DBE Certification Manager

TAB G



Craven Thompson & Associates, Inc.
Engineers • Planners • Surveyors • Landscape Architects

Patrick J. Gibney, P.E.

PROJECT ROLE | Principal-In-Charge

EDUCATION	Bachelor of Science - Civil Engineering Rutgers, The State University 1987
REGISTRATIONS	Professional Civil Engineer - Florida No. 49428 (1995)
CERTIFICATIONS	FDOT Pre-Qualified Roadway Construction Engineering Inspection
AREAS OF EXPERTISE	Civil Engineering
YEARS OF EXPERIENCE	23 Years w/CTA 6 Years w/Other Firms
SUMMARY OF EXPERIENCE	

Mr. Gibney has over twenty-nine years of experience providing project management, design and construction management services for public civil engineering projects. These services include infrastructure improvements for a multitude of infrastructure rehabilitation projects. This includes roadway design & construction, design of water distribution systems, sanitary sewer collection & transmission systems, storm water management systems, drainage systems, preparation of contract documents and specifications and construction inspections.



WORK HISTORY	Craven Thompson & Associates, Inc. , Fort Lauderdale, Florida January 2014 to Present Vice President, Engineering April 1993 to January 2014 Senior Supervising Engineer
---------------------	---

RELEVANT PROJECT EXPERIENCE:

Davie Road Phase 1 CEI Services | Town of Davie, Florida | Project Director

This project was for the construction engineering inspection services to re-construct a public roadway known as Davie Road Phase 1 within public right-of-way owned by Broward County extending from the State Road 84 Right-of-Way to Nova Drive. The length of the reconstruction was approximately 2,640 linear feet. The primary intent was for CTA to provide construction engineering inspection services for the re-construction of the roadway. The work consisted of pavement, base and sub-grade reconstruction, curb & gutter, bike lane, sidewalk and median construction, driveway reconstruction within the Right-of-Way, drainage system construction, landscaping & irrigation construction, pavement marking & signage, traffic signal modification at Reese Road and at Nova Drive, street lighting, and coordination with utility companies.

Resurfacing and ADA Sidewalk Improvements | Miami Gardens, Florida | Project Manager

The resurfacing and ADA walk improvements included approximately 24,000 linear feet of road throughout the city in three neighborhoods. The neighborhoods consist of a mixture of single and multi-family residential dwellings. Significant amounts of the existing roadway infrastructure within these neighborhoods did not meet current ADA requirements, which warranted attention in order to conform to current standards. The project involved coordination with **FDOT for LAP funding** and design criteria, and the development of construction drawings and specifications.

NE 34th Court Complete Streets Project | Oakland Park, Florida | Project Manager

The streetscape and engineering services include full roadway reconstruction design, stormwater management ICPR modeling and design, utility coordination and relocation, landscape and streetscape enhancement, and all associated jurisdictional permitting. This project required permit



approvals from Broward County Environmental Protection Department (EPD), Broward County Health Department, and the City of Oakland Park Public Works and Engineering and Community Development Departments. **This project utilized FDOT LAP funding for construction.** Craven Thompson and Associates assisted the City of Oakland Park with the funding procurement.

NE 38th Street Complete Streets Project | Oakland Park, Florida | Project Manager

The consulting services included landscape and streetscape enhancement, a complete storm sewer system, a roundabout to replace an existing traffic signal, traffic calming devices, utility coordination and relocation, and full roadway reconstruction. The main Project objective was to discourage truck traffic and redirect cut-through traffic from NE 38th Street to alternate routes between Andrews Avenue and NE 11th Avenue. This project required permit approvals from Broward County Environmental Protection Department (EPD), and the City of Oakland Park Public Works and Engineering and Community Development Departments. **This project utilized FDOT LAP funding for construction.**

South County Neighborhood Improvement Project, Broward County – A multi-year project consisting of a 1300 acre infrastructure improvement project in south Broward County. This project consisted of existing residential and commercial development for which gravity and pressure sewer systems will replace existing septic tanks; water main sizing will be improved; and regional drainage will be created where none currently exists. The scope provided for two full time Resident Project Representatives on-site for the course of ten years. The project provided benefits to FDOT for drainage of Pembroke Road, Hallandale Beach Boulevard and SR 7. **Phase V of the project had LAP funding for landscape and sidewalk improvement. CTA had managed the costs and paperwork for the LAP work.** Craven Thompson & Associates, Inc. obtained approval from the State of Florida to use an archeological site, acquired by the State, for stormwater detention, and recreation of historical wetland conditions at the Snake Warrior's Island Park.

NW 21st Avenue Improvements | Fort Lauderdale, Florida | Project Manager

This 1.2 mile roadway project consisted of widening the existing three (3) lane roadway (north-south and bi-directional turn lane) to a five (5) lane roadway (2 north-south travel lanes and a bi-directional turn lane). The Project included a 72" Diameter regional storm drain system that will provide flood protection to approximately 500 acres of existing developments. The 72" storm drain was jacked under the CSX Railroad Tracks and a new outfall was constructed in the C-13 Canal. The work included approximately 5,000 linear feet of water main and force main installation, curb and gutter, landscaping and irrigation, lighting and signalization. Patrick served as the Project Manager for the Project responsible for the inspections of multiple disciplines provided by Sub-consultants and in-house inspectors. The Project began in 2008 and was completed in December 2011.

NE 5th Avenue Streetscape/Roadway Rehabilitation | Oakland Park, Florida | Project Manager

This 0.6 miles roadway project consisted of reconstruction of a two (2) lane roadway, paver intersection and crosswalks, addition of parallel parking stalls, 3,000 linear feet of water main replacement, 2,500 linear feet of storm drain installation, sidewalks, landscaping and irrigation, lighting and franchise utility service placement underground. Patrick was the Project Manager responsible for in-house inspections of the roadway, sidewalks, drainage and water systems as well as coordinating the electrical inspections of a sub-consultant.



CRAVEN • THOMPSON & ASSOCIATES, INC.
Engineers • Planners • Surveyors • Landscape Architects

Patrick J. Gibney, P.E.

PROJECT ROLE | Principal-In-Charge

North Central County Neighborhood Improvements Project | Broward County, Florida | Project Manager - Managed the design and permitting of the stormwater treatment facilities, storm sewer systems, the water distribution systems, the sanitary sewer systems and the roadway modifications for the entire 980 acres. Prepared Contract Documents, Permitting and Construction Management for 980-acre retrofit infrastructure improvements within unincorporated Broward County. Consisted of approximately 21 miles of roadway, 28,359 linear feet of sanitary lines, 21,308 linear feet of watermain, and 17.5 miles of sidewalk.

Central County Neighborhood Improvements Project | Broward County, Florida | Project Manager Preparation of Basis of Design Report, Construction Documents, Permitting and Construction Management for 1,800 acre retrofit infrastructure improvements. Managed the study of the water distribution system, sanitary sewer system, and roadway networks within the project area. Additional recommendations included construction of improvements to the water distribution system, intended to provide adequate service for firefighting capabilities, improvement of the sanitary sewer system intended to eliminate infiltration of groundwater into the system and thereby reduces system operating costs, and the installation of a sanitary sewer system in the existing un-sewered areas of the neighborhoods.



CRAVEN • THOMPSON & ASSOCIATES, INC.
Engineers • Planners • Surveyors • Landscape Architects

Donald Shaver

PROJECT ROLE | Construction Manager

EDUCATION

Bachelor of Science - Construction Science
Kansas State University, Manhattan, Kansas | 1981

Associates in Technical Education, Building Science
Hutchinson Community College, Hutchinson, Kansas | 1978

REGISTRATIONS

State of Florida General Contractor (Inactive)

YEARS OF EXPERIENCE

16 Years w/CTA 19 Years w/Other Firms

SUMMARY OF EXPERIENCE

Mr. Shaver is responsible for coordination with Clients and contractors, supervision of inspection personnel, inspection of infrastructure engineering projects including earthwork, water distribution, sanitary sewer systems, storm drainage and roadways. Performs shop drawing reviews, pay application processing, certifications, construction management and review of record drawings for private and municipal clients.



WORK HISTORY

Craven Thompson & Associates, Inc., Fort Lauderdale, Florida
July 2000 to Present | Director of Construction Services / Construction Manager

RELEVANT PROJECT EXPERIENCE:

Davie Road Phase 1 CEI Services | Town of Davie, Florida | Construction Manager

This project was for the construction engineering inspection services to re-construct a public roadway known as Davie Road Phase 1 within public Right-of-Way owned by Broward County extending from the State Road 84 Right-of-Way to Nova Drive. The length of the reconstruction was approximately 2,640 linear feet. The primary intent was for CTA to provide construction engineering inspection services for the re-construction of the roadway. The construction project consisted of pavement, base and sub-grade reconstruction, curb & gutter construction, bike lane construction, sidewalk construction, median construction, driveway reconstruction within the Right-of-Way, drainage system construction, landscaping & irrigation construction, pavement marking & signage, traffic signal modification at Reese Road and at Nova Drive, street lighting, and coordination with utility companies.

NE/NW 6th Street (Sistrunk Blvd.) Streetscape and Enhancement Project, Fort Lauderdale, Florida

Construction Management services and oversight of Resident Project Representative (RPR) for Sistrunk Blvd. Streetscape and Enhancement Project. The project was funded and managed by the Fort Lauderdale CRA and included streetscape improvements consisting of landscape, median, paver sidewalk, lighting, drainage and other improvements. Work included close coordination with existing businesses during construction, public relations to keep all parties informed of improvements, maintenance of traffic coordination to ensure access to all affected properties throughout construction and a full time RPR on-site managing the project. **The project was federally funded including LAP funding.**



PROJECT ROLE | Construction Manager

South County Neighborhood Improvements Project | Broward County, Florida | Construction Manager
Mr. Shaver was responsible for the construction management of major sections of the South County Neighborhood Improvement Project. The project consisted of twelve construction packages with a total construction cost of approximately \$70 million dollars. Improvements included water distribution, sanitary sewer, lift stations, force main, stormwater improvements and roadway construction. The project included the design, permitting, bidding and construction consisting of 53 miles of roadway, 181,000 linear feet of storm sewer (including exfiltration trench), 140,618 linear feet of water main, 236,226 linear feet of gravity sanitary sewer, and 80 miles of sidewalk. **Phase V of the project had LAP funding for landscape and sidewalk improvement. CTA had managed the costs and paperwork for the LAP work.**

Don Soffer Exercise Path Beautification Improvements | Aventura, Florida | Construction Manager
Mr. Shaver was responsible for Construction Management - Project included design, permitting, coordination with FDOT and construction of improvements to upgrade the City's exercise trail that extends along the entire length of Country Club Drive. **This was a LAP project.** The inspections and reporting for the project were all in accordance with Federal requirements.

Yacht Club Way Bridge | Aventura, Florida | Construction Manager
Mr. Shaver was responsible for Construction Management - Project included design, permitting, coordination with FDOT and construction of repairs and upgrades to existing bridge. **This was a LAP Project.** The inspections and reporting for the project were all in accordance with Federal requirements.

Biscayne Boulevard Decorative Street Lights | Aventura, Florida | Construction Manager
Mr. Shaver was responsible for Construction Management - The Biscayne Boulevard Decorative Lighting Improvements Project included the design, permitting, installation of new light poles along Biscayne Boulevard, and coordination with Miami-Dade County Public Works and **FDOT to ensure LAP compliance.** The lighting improvements encompass the entire City limits along Biscayne Boulevard. The project improvements included the removal of existing light poles and installation of new light poles in accordance with FDOT and Miami-Dade County requirements.

Transit Improvements - New Bus Shelters | Aventura, Florida | Construction Manager
Mr. Shaver was responsible for Construction Management - The project included the installation of two new bus shelters along Country Club Drive. The work involved included design, permitting, coordination of **FDOT LAP Funding** requirements and Miami-Dade County Transit, and construction of the new bus shelters. Country Club Drive is part of the Federal Aid Road System and Country Club Drive has bus stops serving both Miami-Dade County Transit and the City of Aventura's local bus system.

SW 41st Place, Eastside Infrastructure Improvements, Phase I | Davie, Florida | Construction Manager
Responsible for Construction Management of the roadway and right-of-way infrastructure for the SW 41st Place Project. This included roadway reconstruction, new sidewalk, curb & gutter, water, sanitary and drainage. This is Phase I of the Eastside Master Infrastructure Improvements.

Miami Gardens Livable Neighborhoods Improvement Project | Miami Gardens, Florida | Construction Manager - Mr. Shaver was responsible for the construction management of drainage and roadway/right-of-way improvements for the Kings Garden I & II and, Vista Verde Phase IA subdivisions.

Garden Acres Neighborhood Improvements | Oakland Park, Florida | Construction Manager
Mr. Shaver was responsible for Construction management for the construction of the Garden Acres Neighborhood Improvements. The project consisted of water distribution system, sanitary sewer system, lift station, stormwater system and roadway re-construction.



CRAVEN • THOMPSON & ASSOCIATES, INC.
Engineers • Planners • Surveyors • Landscape Architects

Donald Shaver

PROJECT ROLE | Construction Manager

NW 5th Avenue Streetscape/Roadway Improvements | Oakland Park, Florida | Construction Manager

He was responsible for construction management of NW 5th Avenue from Oakland Park Boulevard to NW 38th Street. The project consisted of a water distribution system, a stormwater system and roadway re-construction.

Harlem McBride Area Drainage Improvements | Oakland Park, Florida | Construction Manager

He was responsible for Construction management for drainage and roadway construction of Harlem McBride area. The project consisted of a water distribution system, a stormwater system, and roadway pavement overlay.



CRAVEN-THOMPSON & ASSOCIATES, INC.
Engineers • Planners • Surveyors • Landscape Architects

Marc Woodworth, E.I.

PROJECT ROLE | Construction Inspector

EDUCATION

Bachelor of Science in Civil Engineering and Environmental Engineering
Clarkson University | Potsdam, New York | 1997

YEARS OF EXPERIENCE

17 Years w/CTA, 3 Years w/Other Firms

SUMMARY OF EXPERIENCE

Mr. Woodworth has provided Construction Management Services for the North County Neighborhood Improvement Project, North Central County Neighborhood Improvement Project, and UAZ Projects located in Broward County. His management responsibilities include coordination of project / construction activities. This involves the monitoring, coordinating, and overseeing of project / construction activities from the design phase to construction completion. Other tasks involved within this scope include: quantity takeoffs for payment to contractors; processing of change orders; tracking of all water, sanitary, and drainage testing for certification to various agencies; and review of as-builts



WORK HISTORY

Craven Thompson & Associates, Inc., Fort Lauderdale, Florida
April 1999 to Present | Construction Manager / Project Engineer
Paramount Engineering Group, Inc., Boca Raton, Florida
August 1997 to April 1999 | Survey Crew Party Chief / AutoCAD
Draftsman / Engineer's Assistant

RELEVANT PROJECT EXPERIENCE:

Davie Road Phase 1 CEI Services | Town of Davie, Florida | Construction Inspector

This project was for the construction engineering inspection services to re-construct a public roadway known as Davie Road Phase 1 within public right-of-way owned by Broward County extending from the State Road 84 Right-of-Way to Nova Drive. The length of the reconstruction was approximately 2,640 linear feet. The primary intent was for CTA to provide construction engineering inspection services for the re-construction of the roadway. The construction project consisted of pavement, base and sub-grade reconstruction, curb & gutter construction, bike lane construction, sidewalk construction, median construction, driveway reconstruction within the Right-of-Way, drainage system construction, landscaping & irrigation construction, pavement marking & signage, traffic signal modification at Reese Road and at Nova Drive, street lighting, and coordination with utility companies.

Utility Analysis Zone 310 (UAZ 310) Project | Broward County, Florida | Construction Manager

Responsible for construction management. The UAZ 310 project encompasses approximately 375 acres in the City of Dania Beach. Approximate construction cost is \$10.3 million dollars. The infrastructure improvements to the existing neighborhood include a new water distribution system. The water main improvements include replacement of existing water services and fire hydrants.

North Central County Neighborhood Improvement Project | Broward County, Florida | Construction Manager

- Responsible for construction management. Project consisted of five construction packages with a total construction cost of approximately \$68 million. Improvements included water



CRAVEN-THOMPSON & ASSOCIATES, INC.
Engineers • Planners • Surveyors • Landscape Architects

Marc Woodworth, E.I.

PROJECT ROLE | Construction Inspector

distribution, sanitary sewer, lift stations, force main, storm water improvements and roadway construction.

South County Neighborhood Improvement Project | Broward County, Florida | Construction Manager
Management responsibilities included: performing quantity takeoffs for payment to contractors; processing of Change Orders; tracking of all water, sanitary, and drainage testing for certification to various agencies; review of as-builts for acceptance by Broward County; coordinate & lead weekly progress meetings w/ Broward County & the Contractor. Engineering work included: quantity takeoffs for engineer's estimates: and review of design plans for bid. Oversaw Inspection of the installation of major utilities, construction of roadways, driveways, & swales. **Phase V of the project had LAP funding for landscape and sidewalk improvement. CTA had managed the costs and paperwork for the LAP work.**

North County Neighborhood Improvement Project NE & NW Quadrants | Broward County, Florida | Construction Manager. Responsible for construction management. Project consisted of four construction packages with a total construction cost of approximately \$40 million dollars. Improvements include water distribution, sanitary sewer, lift stations, force main, stormwater improvements and roadway construction.



PROJECT ROLE | Construction Inspector

REGISTRATIONS	Certified for Troxler Nuclear Testing (2009) United States Navy - Mechanical and Safety Inspector on F-14 Tomcat Aircraft. Philips and Jordan Underground Utilities Superintendent for Army Corp. of Engineers project in Hinesville, Georgia.
YEARS OF EXPERIENCE	9 Years w/CTA 10 Years w/Other Firms
SUMMARY OF EXPERIENCE	

Mr. Tull is a Senior Resident Project Representative with nineteen years of experience in all phases of construction inspections on residential, commercial, and governmental projects. Responsibilities include: provide overall supervision of project construction ensuring compliance with the contract requirements; Identify and document non-conformance deficiencies and compile detailed daily reports on the construction progress; Perform daily site observations to document the contractor work progress, equipment and manpower vital to the critical path project schedule; Witness the testing and review the test results for all components used in civil design and construction; Verify, through periodic audits, that Contractor measuring and testing equipment display an appropriate and current calibration sticker; Perform periodic reviews of Contractor work progress, focusing on areas where issues have been noted, areas where work is on the critical path of the Project's Schedule, or areas with a high amount of coordination between Contractor and other entities; Review and comment on the Contractor's construction plans and staging plans focusing on coordination with adjacent projects, issues related to staging, access to site, and schedule; Attend weekly progress review meetings to ascertain job progress, identify potential problems, review the Project schedule, and discuss coordination; Perform final close-out warranty reviews; Periodically review test result submissions and determine what future tests will be observed based on risk factors and prior test results; Monitor and audit, through spot checks, a sufficient number of installation activities to establish confidence in the operability of the systems.



WORK HISTORY	Craven Thompson & Associates, Inc. , Fort Lauderdale, Florida 2007 to Present Senior Resident Project Representative BND Engineering , Miami, Florida 2003 to 2007 Resident Project Representative Miller, Legg and Associates, Inc. , Pembroke Pines, Florida 1999 to 2003 Field Representative
---------------------	--

RELEVANT PROJECT EXPERIENCE:

Davie Road Phase 1 CEI Services | Town of Davie, Florida | Construction Inspector
This project was for the construction engineering inspection services to re-construct a public roadway known as Davie Road Phase 1 within public right-of-way owned by Broward County extending from the State Road 84 Right-of-Way to Nova Drive. The length of the reconstruction was approximately 2,640 linear feet. The primary intent was for CTA to provide construction engineering inspection services for the re-construction of the roadway. The construction project consisted of pavement, base and sub-grade reconstruction, curb & gutter construction, bike lane construction, sidewalk construction, median construction, driveway reconstruction within the R.O.W., drainage



CRAVEN • THOMPSON & ASSOCIATES, INC.
Engineers • Planners • Surveyors • Landscape Architects

PROJECT ROLE | Construction Inspector

system construction, landscaping & irrigation construction, pavement marking & signage, traffic signal modification at Reese Road and at Nova Drive, street lighting, and coordination with utility companies.

NE/NW 6th Street (Sistrunk Blvd.) Streetscape and Enhancement Project, Fort Lauderdale, Florida

Responsible for Construction Engineering Inspection services for Sistrunk Boulevard Streetscape and Enhancement Project. The project was funded and managed by the Fort Lauderdale CRA and included streetscape improvements consisting of landscape, median, paver sidewalk, lighting, drainage and other improvements. Work included close coordination with existing businesses during construction, public relations to keep all parties informed of improvements, maintenance of traffic coordination to ensure access to all affected properties throughout construction and a full time RPR on-site managing the project. **The project was federally funded including LAP funding.**

Garden Acres Neighborhood Improvements, Oakland Park, Florida

Responsible for construction management. The infrastructure improvements to the existing neighborhood include a storm sewer, exfiltration trench, structures, milling & resurfacing, roadway reconstruction, and ROW restoration.

North County Neighborhood Improvement Project Bid Package 8, Broward County, Florida

Construction management responsible for the Infrastructure improvements project.

North County Neighborhood Improvement Project Bid Packages 3, Broward County, Florida

Construction management responsible for the Infrastructure improvements project.

North County Neighborhood Improvement Project Bid Package 4, Broward County, Florida

Construction management responsible for the Infrastructure improvements project.

Davie Road Phase I Roadway Improvements, Davie, Florida

Resident Project Representative responsible for construction oversight of the roadway widening project.



CRAVEN-THOMPSON & ASSOCIATES, INC.
Engineers • Planners • Surveyors • Landscape Architects

Joseph D. Handley, R.L.A.

PROJECT ROLE | Senior Landscape Architect/ LA CEI

EDUCATION	B.S. in Ornamental Horticulture Clemson University 1976 - 1980 Attended Masters in Landscape Architecture Program University of Georgia and Louisiana State University 1981 - 1984
REGISTRATIONS	Professional Registered Landscape Architect - Florida No. 1368 (1990)
YEARS OF EXPERIENCE	28 Years w/CTA, 5 Years w/Other Firms

SUMMARY OF EXPERIENCE

Mr. Handley has been involved in a broad range of land planning projects in South Florida for the past thirty-three years. Having worked in both the public and private sectors, Mr. Handley is widely familiar with client needs and project requirements and processes. He is responsible for overseeing the preparation and processing of plats, site, landscape, hardscape, streetscape and irrigation plans; utilizing his knowledge of local, state and federal regulations involved in land development. He also has extensive experience with landscape, hardscape, and irrigation construction.



WORK HISTORY	Craven Thompson & Associates, Inc. , Fort Lauderdale, Florida September 1993 - Present Vice President, Planning and Landscape Architecture February 1988 - September 1993 Senior Land Planner
---------------------	--

RELEVANT PROJECT EXPERIENCE:

NE 38th Street Complete Streets Project (Andrews Avenue to NE 11th Avenue) | Oakland Park, Florida | Principal Landscape Architect - Landscape, streetscape and irrigation design for the roadway reconstruction design of approximately 0.90 miles of roadway improvements including neighborhood traffic calming. **This project utilized FDOT LAP funding for construction.**

NE 34th Court Complete Streets Project (NE 2nd Avenue to Dixie Highway) | Oakland Park, Florida | Principal Landscape Architect - Landscape, streetscape and irrigation design for the roadway reconstruction design of approximately 0.60 miles. **This project utilized FDOT LAP funding for construction.**

Sistrunk Boulevard Streetscape (NW 24th Avenue to South Federal Highway) | Fort Lauderdale, Florida | Principal Landscape Architect - Landscape, streetscape and irrigation CEI for the roadway reconstruction design of approximately 2.3 miles. **The project was federally funded including LAP funding.**

South County Neighborhood Improvements Project | Broward County, Florida | Principal Landscape Architect - Preparation of Basis of Design Report, Construction Documents, Permitting and Construction Management for 1,400 acre retrofit infrastructure and landscape improvements within unincorporated Broward County. **The project had LAP funding for landscape and sidewalk improvement. CTA had managed the costs and paperwork for the LAP work.**

Sense of Place Signage | Oakland Park, Florida | Principal Landscape Architect
Redesign of the entry features for the Royal Palm Isles and South Royal Palm Acres.



CRAVEN-THOMPSON & ASSOCIATES, INC.
Engineers • Planners • Surveyors • Landscape Architects

Joseph D. Handley, R.L.A.

PROJECT ROLE | Senior Landscape Architect/ LA CEI

Northwest 125th Street (SR7 to NW 17th Avenue) | North Miami, Florida | Principal Landscape Architect - Landscape, streetscape and irrigation design for the roadway reconstruction design of approximately 1 mile.

NE 5th Avenue Streetscape/Reconstruction (Oakland Park Boulevard to NE 38th Street) | Oakland Park, Florida | Principal Landscape Architect - Landscape, streetscape and irrigation design for the roadway reconstruction design of approximately 0.60 miles.

Broward Boulevard (Pine Island Road to University Drive) | Plantation, Florida | Principal Landscape Architect - Landscape, streetscape and irrigation design for the roadway reconstruction design of approximately 0.80 miles.

NW 21st Avenue (Oakland Park Boulevard to NW 19th Street) | Oakland Park & Fort Lauderdale | Principal Landscape Architect - Landscape, streetscape and irrigation design for the roadway reconstruction design of approximately 1 mile.

Sunrise Bicycle/Pedestrian, Greenways and Trails Master Plan | Sunrise, Florida | Principal Landscape Architect - Craven Thompson & Associates, Inc. along with Alta Planning + Design was hired by the City of Sunrise to prepare a Bicycle / Pedestrian Greenways & Trails Master Plan. The Plan defines a system of sidewalks, bike lanes, paths, greenways and trails within the City of Sunrise that provides integrated and continuous corridors for non-motorized transportation and recreation throughout the city in a manner that is sensitive to the needs of various user groups, the natural and built environment, the management and maintenance, and potential funding capabilities of local government.

Oak Hammock Park and Cypress Preserve Park | Sunrise, Florida | Principal Landscape Architect - Construction Cost: \$8 Million. These 2 passive parks developed under the Broward County Parks Bond Program include upland and wetland restoration, a splash pad, a nature-themed playground, restroom and storage buildings, jogging paths, picnic shelters and canal boardwalk.

Pine Island Road (Commercial Boulevard to Oakland Park Boulevard) | Sunrise and Tamarac, Florida | Principal Landscape Architect - Landscape, streetscape and irrigation design for the roadway reconstruction design of approximately 1 mile.

North Central County Neighborhood Improvements Project | Broward County, Florida | Principal Landscape Architect Preparation of Basis of Design Report, Contract Documents, Permitting and Construction Management for 980-acre retrofit infrastructure and landscape improvements within unincorporated Broward County.

Central County Neighborhood Improvements Project | Broward County, Florida | Principal Landscape Architect - Preparation of Basis of Design Report, Construction Documents, Permitting and Construction Management for 1,800 acre retrofit infrastructure and landscape improvements within unincorporated Broward County.

Strada Streetscape | Coconut Creek, Florida | Principal Landscape Architect - This project is an 8.3 acre commercial development in Coconut Creek, located on the corner of Coconut Creek Parkway and Lyons Road. Strada was planned, and is being developed, as a commercial village with retailers, professional and medical offices, two financial institutions and a hotel. A Site Plan was developed that integrates the needs of the community, the City requirements and the Developer's vision. A unique feature of the plan is the "pedestrian spine" that connects the various uses together and culminates in plazas on both Coconut Creek Parkway and Lyons Road. CTA was also responsible for the Hardscape as well as the Landscape design.



German J. Sanchez, EI Engineering Intern

With more than 14 years of experience, German Sanchez is a Senior Designer working on projects involving lighting, signing and pavement markings, signalization, drainage, maintenance of traffic and roadway design. He is also responsible for performing quality control, ensuring that projects meet all requirements outlined in the FDOT CADD Production Criteria Handbook and CADD Manual.

German has experience in overseeing the Construction Engineering & Inspection (CEI) of over 100 railroad rehabilitation projects which included participating in public information meetings, inter-agency coordination, maintenance of traffic and final reports to FDOT.

Years of Experience: 14

AREAS OF EXPERTISE

Design
Construction Management
CEI Oversight

EDUCATION

BS in Civil Engineering, Florida
International University, 2010

REGISTRATIONS

Engineer in Training
Florida 1100016287, 2011

CERTIFICATIONS

SFRTA Roadway Worker
Protection Contractor Safety
11/2015

FEC Roadway Worker
Protection 02/2016

Maintenance of Traffic
Advanced 08/2015

CTQP Asphalt Paving Level 1
08/2015

CTQP Earthwork Construction
Inspection Level 1 08/2015

WORK HISTORY

Marlin Engineering, Inc.
11/2015-Present
Engineering Intern

MPG Pipeline Contractors
01/2014-01/2015
Project Coordinator

GueSanc Corp.
01/2013-12/2013
President

Marlin Engineering, Inc.
04/2009-06/2012
Roadway Designer

NW 92nd Avenue | City of Doral | CEI Inspector: Provides field observation and oversight to the construction improvements of NW 92nd Avenue in the City of Doral. This includes coordination between governing agencies, overseeing safety concerns, and ensuring compliance with MOT plans. In addition, MARLIN will verify quantities installed by the Contractor and make payment recommendation to the City. (9/2016-Ongoing)

Districtwide General Engineering Contract | FDOT District 4 | Rail Inspection Specialist: Team member in SFRC inspection and railroad crossing condition evaluation project. Visited 73 state owned, at-grade railroad crossings and inspected the conditions, recorded survey data and evaluated the overall rating for the individual crossings. Helped to modify the evaluation process currently used to include pedestrian factors and train factors. Worked on the FEC corridor inspecting the All Aboard Florida double tracking construction on State owned crossings. Inspected the crossing to ensure that FDOT Design standards were being followed.

Tamiami Trail Next Bridge Design-Build | FDOT District 6 | Senior Designer: Team member assisting in designing the 2.6 mile project. Production of roadway plans including three bridges as well as the signing and pavement markings.

NW 92nd Avenue Extension Project | City of Doral | Senior Designer: Team member assisting in designing the signing and pavement markings for the extension of the roadway from 500' North of NW 25th Street to a new intersection at NW 36th Street.

MPG Pipeline Contractors | Project Coordinator: Assisted Director of Safety in the translation of safety material for the Spanish speaking field personnel to a Spanish written manual, Orientation and Comprehension Test. Reviewed third party orientation presentation for Quality Assurance and ensured that proper Spanish was used for the region and Employee Manual. Attended multiple Pre-Bid meetings in Texas, Louisiana, and Oklahoma for the company to qualify to bid. Acted as a Field Supervisor for two projects De-Mobilizing in Rosenberg, TX and near Corpus Christi, TX. Further, and supervised loading of equipment and 30" pipe from project yard to new projects in Louisiana and Houston TX. (2014-2015)

Districtwide Office of Modal Development Contract | Broward County to Indian River County | Roadway Designer: Roadway Designer responsible for the development of traffic control plans for full closure of state roads in FDOT District 4 for the rehabilitation of railroad crossings with FEC and CSX railways. In the last 8 years, performed between 10 to 16 crossings annually. Coordination with governmental agencies and general public was critical to minimize the impact to traffic. Participated as a team member of yearly work plan visits from central office



and special projects, like quiet zones along railway corridors suggesting roadway modifications to provide the safest railroad crossings possible. Reviewed the contractor's invoice and submitted a final report to FDOT D4. Implemented QA of nightly set-up in order to minimize impact to traffic at time of closure. Represented the company at all public meetings with FDOT District 4. (2004-2012)

Biscayne Trail Segment C | Miami-Dade County | Designer: LAP PROJECT. A seven mile shared use path built on top of Army Corps of Engineers levee. Coordinated the permitting process and represented the company's design team at meetings with the County Parks agency. Performed detailed site survey ensuring that parameters set by permitting agency in design were met. Represented the design team and coordinated with the planning department within the company that acted as the point of contact with the project manager from the County Parks agency and other governmental agencies. (2011-2012)

N.W. 25th Street (West Segment) Post-Design | FDOT District 6 | Designer: Assisted contractor by answering any questions or issues that were encountered during redesign of contract plans. Represented Company in meetings with contractor and FDOT. Provided plans and boards to public information officer for public meetings and meetings with County advisory boards. Attended meetings with local agencies and business owners during public meetings to answer any questions regarding the benefits of the project. Assisted contractor to expedite review by FDOT and other local governmental agencies of redesign plans by contractor. Would personally visit FDOT and County to ensure that approval of plans would be done in a timely manner. (2011-2012)

SR-997 Krome Avenue Reconstruction | FDOT District 6 | Designer: Responsible for maintenance of traffic for the reconstruction of a two lane undivided major rural arterial and converted it to four lane divided roadway from North of SW 8th Street to South of SW 88th Street (Kendall Drive). Responsible for quality control of roadway plans and full implementation of review comments. Assisted Project Engineer during meetings with business owners along corridor including Miccosukee Casino. Performed peer review for quantities in computation book and transport website by FDOT. (2010-2012)

Highland Village Sewer Connection Project | City of North Miami Beach | CEI Coordinator: CEI Coordinator responsible for overseeing the contractor to ensure that plans and specifications were followed. The project involved connecting 220 properties to sewer mainline. Reviewed and approved contractor's invoices and developed reports for client outlining weekly progress at project. Represented the CEI Team at progress meetings with the City and Contractor. Assisted city officials in assuring that all paperwork required was completed by property owners allowing the contractor onto their property. (2008-2009)

N.W. 25th Street (West Segment) Reconstruction | FDOT District 6 | Designer: Team leader responsible to update plans to new standards and get plans approved for construction through expedited review by FDOT construction office. Successfully submitted plans electronically for this 1,200 sheet project involving seven sub-consultants. Acted as deputy project manager in meetings with FDOT construction representatives and other disciplines allowing for a smooth review for a project that had been put on hold for over 2 years due to funding issues in the work program. (2008-2011)

N.W. 25th Street (East Segment) Post-Design | FDOT District 6 | Designer: Responsible to attend weekly meetings and field meetings to identify construction issues raised by contractor and to provide solutions in a timely manner in order for construction schedules to not be impacted. Acted as the deputy project manager and would be the initial point of contact for FDOT construction manager, Dari Vorce, and the CEI project manager, Nelson Perez. Would meet with Engineer of Record weekly and provide a breakdown of the issues and would advise EOR when his presence was necessary at a crucial meeting. Reviewed shop drawings and would meet with FDOT and County when their reviews were a required step in the process, tracked requests for information and performed all CADD work for the 4 year construction duration. (2006-2010)

N.W. 25th Street (East Segment) | FDOT District 6 | Designer: Responsible for roadway plans and computation books. Assisted in the production of the signing and pavement marking plans and reviewed the quantities shown in the tabulation of quantities sheets. Assisted with the signalization plans and also quantifying for pay items used on tabulation of quantities sheets. In charge of implementing the Electronic Delivery process expected by FDOT and handled the EDI including traveling to Central Office to allow the developers to work out bugs in the software due to the large size of the project (over 1300 sheets). Personally would deliver plans and documentation to FDOT personnel to ensure that project was submitted ahead of schedule. Responsible to meet with the reviewers from FDOT and the County to make sure that implementations would satisfy their review comments. (2003-2006)

Wael “Maj” Majdalawi, PE, PTOE

Executive Vice-President

Experience

29 years
24 Years Post Registration
16 Years with PD&E

Registration

PE No. 42646 (Civil) (1990)
IMSA Signal No SI-80017
PTOE No. 2763 (2010)

Education

BS, 1985,
Civil Engineering
University of Kentucky

Expertise

Project Management
Experience in Traffic and
Transportation Engineering

Extensive experience in
Traffic Engineering Design,
Traffic Studies, Highway
Design, and Traffic Control
Plans

Extensive knowledge of
District 4 & 6 design practices
and policies/procedures

Professional Profile

Mr. Majdalawi has been involved in various aspects of transportation engineering, highway design and traffic engineering related matters. His broad background in both design and traffic engineering for FDOT as well as private developers coupled with his public sector experience enables Mr. Majdalawi to view the projects he manages from a system-wide perspective rather than using a narrow, single discipline approach. This perspective allows him to better manage a project team that includes specialists and to guide them to a balanced and cost effective solution.

He has managed numerous projects for the FDOT Districts VI and IV and for private developments. The projects varied from intersection improvements to full reconstruction of six-lane divided arterial and interchange improvements. The projects involved the preparation of Traffic studies, Conceptual plans traffic control plans, geometric, highway design, drainage improvements, signing and marking, lighting and signalization plans.

Experience

FDOT District IV - Design Services for Safety Projects

Prepared design plans for District letting based on approved safety studies. The projects utilize safety funds and include drainage, signalization, structures, surveying, public involvement and utilities certification.

(Prime Consultant 10/2010 –Present)

FDOT District IV – District wide Traffic Operations Conceptual Studies

Prepared conceptual traffic studies for various projects throughout District Four. The studies involved strong project management experience in preparation of conceptual plans that included strong design and traffic operations combined experience. The project involved the development of creative conceptual plans that meets FDOT design standards within constraint urban corridors with very limited right-of-way. The project included extensive traffic operations analysis and design that covered facets of arterials with extensive public involvement. (Prime Consultant 4/2001 – 8/2010)

FDOT District IV – District wide Traffic Operations Studies

Prepared variety of traffic studies for various intersections throughout District Four. The project included extensive multi traffic operations analysis and design studies that included signal warrant, Signals strain poles analysis, intersections studies, signal design and minor design plans. (Prime Consultant 9/2001 – 11/2005)

FDOT District IV – District wide Traffic Operations Minor Design

Developed and managed numerous minor design push button assignments throughout District Four. The assignments included District letting and Tallahassee lettings including federal aid projects. (Prime Consultant 4/2001 – 4/2003)

FDOT District VI – District wide Traffic Operations Minor Design

Developed and managed numerous minor design push button assignments throughout District Six. The assignments included District letting and Tallahassee lettings including federal aid projects. (Prime Consultant 2/2001 –2/2003)

Palm Beach County Signal Design Projects

Developed and managed signal design projects throughout Palm Beach County. The assignments included post design services and construction assistance services. (Prime Consultant 2007 –2011)

Palm Beach County Signal Retiming Contract

Developed five signal retiming plans for 20 intersections along Linton Blvd and US-1 (Federal Highway) in Palm Beach County. The timing plan included implementation, calibration and initial extensive field development. (Sub Consultant 2010 –2012)

Gary Robeson, PE

Director of Engineering

Experience
28 years

Registration
FL PE No. 53046 (Civil)
PA PE No. 55988 (Civil)
GA PE No. 23791 (Civil)
IMSA Signal No. SI-80020
(Signal Inspector)
FDOT Intermediate MOT
No. 9226

Education
BS, University of Pittsburgh
1986
Engineering

Expertise
FDOT D-4 Design & Project
Management Experience in
Roadway and Transportation
Engineering

Proficiency in MicroStation,
GEOPAK, DesCartes, GuidSign
and Auto Turn

Experience with Minor Design
and Districtwide contracts

Experience with D4 in complex
geometric highway design and
plans preparation.

Extensive knowledge of District
4 design practices and
policies/procedures

Office Location
Delray Beach, FL

Years with current firm
16 years

Professional Profile

Mr. Robeson has more than 25 years of experience as a project and technical manager for transportation engineering projects for the public and private sectors. He prepared roadway design plans for numerous roadway projects. His roadway design experience included the preparation of horizontal and vertical alignments; signalization plans of span wire and mast arm, signing and pavement marking plans, overhead guide signing, drainage plans, utility design and relocation, traffic control plans, highway lighting plans and the preparation of Construction Estimates (TRANSPORT) and Long Range Estimates (LRE) for numerous FDOT projects.

Relevant Project Experience

FDOT District Four Traffic Operations Conceptual Studies (2001-2010)

Prepared numerous conceptual roadway plans that involved complex urban improvements within limited right-of-way. The contract included special plans presentations and extensive collision diagram developments for arterials throughout District Four.

FDOT District Four Traffic Operations Studies (2002-2007)

Prepared numerous intersection plans that was included in signal warrant studies, intersections analysis and strain poles analysis. The contract included special plans presentations and extensive collision diagram developments. The project also included the development of minor design plans.

FDOT District Six Traffic Operations Minor Design Contract (1999-2003)

Prepared construction plans for numerous Push Button Contracts in the Florida Keys and Dade County.

FDOT District Four Traffic Operations Minor Design Contract (2001-2005)

Prepared construction plans for numerous Push Button Contracts from Broward County to Indian River County.

Commercial Boulevard (2001-2005)

Completed the design of several mast arm signals and overhead guide signs on SR-870 (commercial Blvd) from Powerline Rd. to NE 19th St. The project included public presentations and District letting.

Lake Worth Road (2006-2008)

Completed the design of several mast arm signals on Lake Worth Road from the Florida's Turnpike to East of Military Trail. The project involved District lettings and specification package submittal.

Puerto Rico Highway Authority (1998-2000)

PR 53 from intersection of PR 181 to PR 723 Patillas-Arroyo, Puerto Rico. Design of two diamond interchanges and four lane divided expressway

FDOT District IV (1996-2000)

US 1 (SR 5) from Copans Road to Sample Road reconstruction and drainage plans. This project included pavement design, utilities, drainage analysis reports, signalization, access management, and permitting.

FDOT District IV (1994-1998)

SR 834 (Sample Road) from SR 7 (US-441) to Rock Island Road. Resurfacing and widening 1.4 miles of a four-lane divided section to a six-lane divided section. This project included a combination of positive and swale drainage.

TAB H



CRAVEN • THOMPSON & ASSOCIATES, INC.
Engineers • Planners • Surveyors • Landscape Architects

REFERENCES

LOCAL AGENCY PROGRAM (LAP) PROJECTS

The following are the latest three **Local Agency Program (LAP) Projects** completed by Craven Thompson & Associates, Inc. (CTA):

NE 38th and NW 38th Street Complete Streets Project, Oakland Park, Florida

Client:

City of Oakland Park
5399 N. Dixie Highway
Oakland Park, Florida 33334
Contact: Mr. Harris Hamid, P.E.
Former Assistant Director Engineering &
Community Development
Phone: (305) 586-3739
Email: harrishhamid@semtribe.com



Design Completion Date: June 2011

Construction Completion Date: June 2016

Consultant Fees: \$320,000.00

Construction Cost: \$4.5 Million

Project Summary:

This project involved the provision of professional engineering services for the design and permitting of approximately 1.50 miles of roadway/streetscape improvements for two (2) Phases of the 38th Street Complete Streets Project that utilized FDOT LAP funding for construction.

The consulting services included coordination with FDOT regarding LAP requirements, landscape, hardscape, and streetscape enhancement, a complete storm sewer system, a roundabout to replace an existing traffic signal, traffic calming devices, utility coordination and relocation, and full roadway reconstruction. The main Project objective was to discourage truck traffic and redirect cut-through traffic from NE 38th and NW 38th Street to alternate routes between Andrews Avenue, NW 10th Avenue and NE 11th Avenue. This project required permit approvals from Broward County Environmental Protection and Growth Management Department (BCEPGMD), and the City of Oakland Park Public Works and Engineering and Community Development Departments. This project utilized **FDOT LAP funding** for construction.

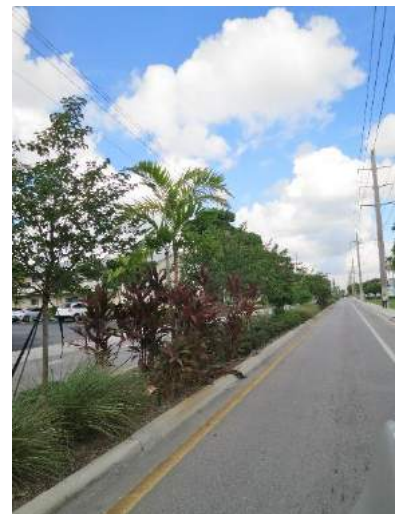



Craven Thompson & Associates, Inc.
Engineers • Planners • Surveyors • Landscape Architects

Resurfacing and ADA Sidewalk Improvement Project, Miami Gardens, Florida

Client:

Mr. Tom Ruiz, CGC, CFM
Public Works Director
City of Miami Gardens
1050 NW 163rd Drive
Miami Gardens, Florida 33169
Phone: (786) 279-1260
Email: truiz@miamigardens-fl.gov

Project Start / Completion Date: June 2009 / 2014

Construction Budget: \$1,632,000.00

CTA Fees: \$32,000.00

Project Summary:

The scope of services included preparation of resurfacing plans, ADA sidewalk and ramp improvement plans, calculations for asphalt resurfacing, permitting, shallow borings, and assistance during construction.

The resurfacing and ADA walk improvements included approximately 24,000 linear feet of road throughout the City in three neighborhoods. The neighborhoods consist of a mixture of single and multi-family residential dwellings. Significant amounts of the existing roadway infrastructure within these neighborhoods did not meet current PROWAG and ADA requirements, which warranted attention in order to conform to current standards. In order to address the infrastructure needs, the City of Miami Gardens selected Craven Thompson & Associates, Inc. to analyze the roadway corridors within the project areas to determine necessary resurfacing and ADA improvements. Craven Thompson prepared plans for the resurfacing of all roads after having borings prepared to analyze the existing roadway conditions. Concurrently, the area was reviewed for sidewalk and PROWAG / ADA improvements to ensure compliance with PROWAG and/or ADA standards. The project involved coordination with **FDOT for LAP funding** and design criteria, and the development of construction drawings and specifications.

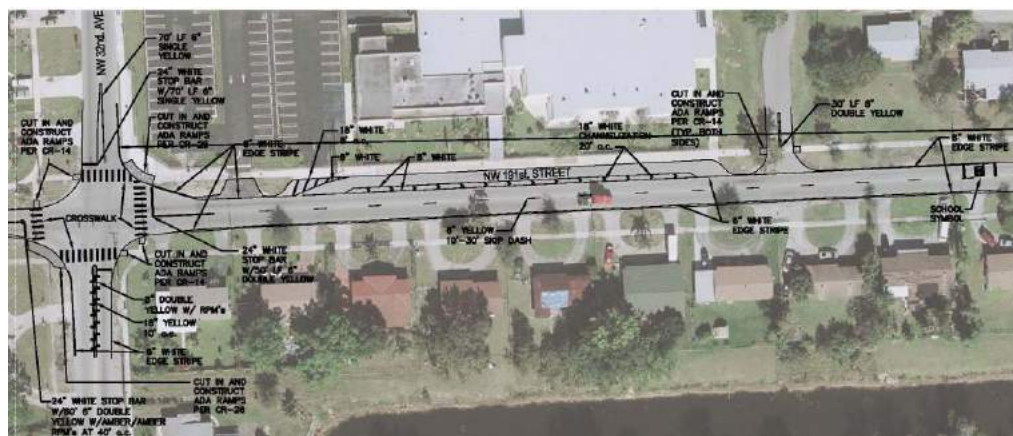



CRAVEN THOMPSON & ASSOCIATES, INC.
Engineers • Planners • Surveyors • Landscape Architects

NE/NW 6th Street (Sistrunk Blvd.) Streetscape and Enhancement Project, Fort Lauderdale

Client:

Mr. Mark S. Friedman, AIA, NCARB, Project Manager II
Engineering/Architecture Division
Public Works Department
City of Fort Lauderdale City Hall, Fourth Floor
100 N. Andrews Avenue, Fort Lauderdale, Florida 33301
Phone: (954) 828-5952
Email: mfriedman@fortlauderdale.gov



Project Start / Completion Date:

December 2010 / December 2012

CTA Fees:

Contract Amount: \$1,436,722.00 / Billed Amount: \$1,385,797.18

Construction Cost:

Original: \$13,401,068, Final: \$13,981,785.00 (9 Change Orders)

Project Summary:

Craven Thompson and Associates represented the City of Fort Lauderdale as the Resident Project Representative for the Sistrunk Boulevard Streetscape and Enhancement Project. While the design of this project was managed by the City’s Community Redevelopment Agency (CRA) the construction portion is administered by the City of Fort Lauderdale’s Public Works Department. Primary funding for construction was provided by the Fort Lauderdale CRA. The project area encompasses 2.5 miles of Sistrunk Boulevard (NE / NW 6th Street) from Federal Highway to NW 24th Avenue and includes streetscape and infrastructure improvements consisting of landscaped medians, paver sidewalks, decorative street lighting, traffic signal mast arm installations, undergrounding of overhead utilities, drainage improvements, new water mains and the relocation of various sanitary sewer lines. Construction cost was approximately \$14 million dollars. Work included on-site resolution of construction conflicts and design changes, construction inspection services for quality control and project certification, coordination with FPL, AT&T and Comcast for utility conversions from overhead to underground, close coordination with existing businesses during construction, public relations to keep all parties informed of the ongoing improvements, maintenance of traffic coordination to ensure continuous access to all affected properties, monthly Pay Application reviews, Change Order reviews and various other construction management duties. **This project was partially, federally funded through FDOT LAP funding.**



Before



After



Greenways Biscayne Trail is a 36.2 mile long multi-use trail study that includes a PD&E study, trail design and construction management services. The Biscayne Trail provides recreational access to Biscayne National Park and several of South Florida's coastal habitats. For the purposes of this study, the trail was divided into four segments: A, B, C and D. Segment C is approximately 6 miles in length by itself. However, the total length of this segment is 6.5 miles with one additional spur approximately 0.5 miles in length located on the south side of the Mowry (C-103) Canal (theoretical SW 320th St.) to Biscayne Bay. Segment D is approximately 4 miles in total length. This was a LAP project.

MARLIN prepared a study documenting the requirements for preliminary design, including existing conditions, typical sections, right-of-way requirements, environmental impacts, development of three Build alternatives and costs of improvements on the Biscayne Trail Segment C & D. This study was performed in accordance with FDOT's PD&E Manual. Study tasks include:

- Collection of all existing engineering and environmental data for possible improvements to the existing L-31 E and North Canal levee.
- Recommendation of corridor development, based on subsequent data analysis based on operational, safety and aesthetic improvements.
- Consideration of improvements positively impacting safety and operations throughout the surrounding corridor.
- Identification of all existing deficiencies and development of alternatives
- Recommendation of a preferred alternative in the study of Segments C&D connecting Black Creek Trail Segment A with SW 137th Avenue (Speedway Blvd.)
- Documentation of the analysis and conclusions in reports
- Final Design Plans, and
- Construction documents and construction management.

Greenways Biscayne Trail Segments C&D

Client
Miami-Dade County

Services
Design
Surveying
Traffic Engineering
Transportation Planning



CRAVEN • THOMPSON & ASSOCIATES, INC.
Engineers • Planners • Surveyors • Landscape Architects

PRIOR PROJECTS FOR THE TOWN OF DAVIE

The following are prior projects for the Town of Dave performed by Craven Thompson & Associates, Inc. (CTA):

Davie Road Phase 1 - CEI Services, Davie, Florida

Client:

Ms. Laura Borgesi, P.E.

Town Engineer

Town of Davie

6591 Orange Drive

Davie, Florida 33314

Phone: (954) 797-1082

Fax: (954) 797-1086

Email: laura_borgesi@davie-fl.gov

Project Services Date: 2015 - 2016

CTA Fees: \$255,760.00

Construction Costs: \$3,665,750.00

Project Summary:

This project provided Construction Engineering Inspection (CEI) services to the Town to re-construct Davie Road Phase 1 within public Right-of-Way owned by Broward County extending from the State Road 84 Right-of-Way to Nova Drive. The primary intent was for CTA to provide Construction Engineering Inspection services for the re-construction of approximately 2,640 linear feet of the roadway. The construction project consisted of pavement, base and sub-grade reconstruction, curb & gutter, bike lane, sidewalk and ramp construction, median construction, driveway reconstruction, minor storm drainage improvements within the Right-of-Way, landscaping & irrigation improvements, pavement marking and signage, street light improvements, traffic signal modification at Reese Road and at Nova Drive and coordination with franchise utility companies.





CRAVEN THOMPSON & ASSOCIATES, INC.
Engineers • Planners • Surveyors • Landscape Architects

SW 41st Place Roadway & Infrastructure Improvements, Davie, FL

Client:

Mr. Giovanni Moss,
Community Development Director
Town of Davie
4700 Davie Road, Suite D
Davie, Florida 33314
Phone: (954) 797-1173
Email: gmoss@davie-fl.gov

Start / Completion Date: 2008 - 2011

CTA Fees: \$135,388.00 (includes 2 Additional services
in the amount of \$33,238.00)

Engineer’s Cost Estimate: \$1,322,908.00

Initial Bid Cost: \$1,141,903.00

Final Construction Cost: \$1,173,716.00
(includes 6 Change Orders for \$31,813.90)

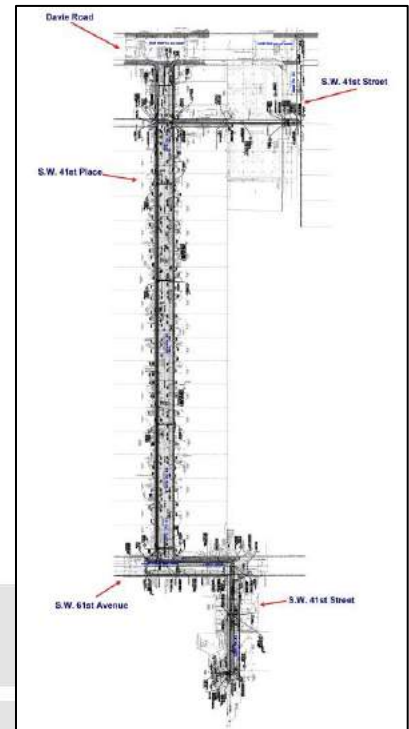

Project Summary:

Craven Thompson completed the SW 41st Place Infrastructure Improvements for the Town of Davie Community Redevelopment Agency in 2011. This project included the demolition of existing utilities, installation of large diameter storm drain, water main, sanitary sewer and roadway/sidewalk as part of Phase I of the Eastside Master Drainage Study and Eastside water and sanitary sewer improvements. Craven Thompson & Associates, Inc. provided design and permitting services for roadway, water, sanitary and drainage as well as Resident Project Representative services including shop drawing review, meeting coordination, field observation, review and coordination of pay requests, change orders and Requests for Information. Services also included Project close-out, Substantial and Final Completion, review of Record Drawings and Certification of Permits to applicable agencies. The project included 1,675 linear feet of watermain construction and 1,272 linear feet of sanitary sewer collection system construction. The project was permitted through the FDEP (EPA), Broward County DERD – WW, Broward County – SWM, and SFWMD.





CRAVEN • THOMPSON & ASSOCIATES, INC.
Engineers • Planners • Surveyors • Landscape Architects

Eastside Master Infrastructure Project, Davie, Florida

Client:

Mr. Giovanni Moss, Community Development Director
Town of Davie
4700 Davie Road, Suite D
Davie, Florida 33314
Phone: (954) 797-1173
Email: gmoss@davie-fl.gov

Design Dates: 2015 - 2016

Construction: 2016 - 2017 (Estimated)

CTA Fees: \$2,888,765.00

Construction Cost: \$13,275,149.00

Project Summary:

Craven Thompson & Associates, Inc. (CTA) performed **surveying, subsurface locates**, design and permitting for approximately 340 acres within the CRA, east of Davie Road, north of Orange Drive and south of SW 36th Court and west of SW 53rd Avenue. The Master Infrastructure Study provided the basis for infrastructure improvements within the CRA Eastside. Phasing plans were prepared which provided infrastructure in those areas being considered for redevelopment in the foreseeable future. The drainage portion of the Master Study was approved by Central Broward Water Control District.



This construction provides drainage infrastructure for the development of a portion of the Downtown Master Plan Area as well the redevelopment of SW 41st Court. The basic infrastructure work consists of replacement of the existing water distribution system and new installation of sanitary sewer system and storm drainage system. The work also includes several miles of roadway reconstruction with landscaping and sidewalks. The water distribution was designed and permitted by CTA, included 14,800 linear feet of 6" diameter main, 5,075 linear feet of 8" diameter main, and 5,140 linear feet of 12" diameter main. The sanitary improvements included 11,455 linear feet of 8" diameter pipe, 40 sanitary manholes and 2,945 linear feet of 16" diameter forcemain. The project also included 18,940 linear feet of storm sewer and the reconstruction of 5.2 miles of roadway. Giannetti is the contractor.



CRAVEN • THOMPSON & ASSOCIATES, INC.
Engineers • Planners • Surveyors • Landscape Architects

Davie CRA Parking Lot, Davie, Florida

Mr. Giovanni Moss
Community Development Director
Town of Davie
4700 Davie Road, Suite D
Davie, Florida 33314
Phone: (954) 797-1173
Email: gross@davie-fl.gov

Project Start / Completion Dates: 2010 – 2012

CTA Fees: \$21,050.00

Estimated Construction Cost: \$75,070.00

Final Construction Cost: \$73,392.00 (No Change Orders)

Project Summary:

As Consulting Engineer for the Town of Davie Community Redevelopment Agency, CTA is helping rejuvenate the downtown area and helping to create much needed pedestrian corridors, as well as upgrading the infrastructure. This design concept of back-of-house parking is geared towards creating a main street in downtown Davie to accentuate an urban setting through the Town. Instead of the current pull-in parking and large driveway openings, which present a hazardous situation for pedestrians, a safe and comfortable pedestrian corridor has been constructed. With large dining patios, landscape strips, site furnishings and the addition of on-street parallel parking, the existing buildings now have the perfect opportunity for a facelift. Hopefully with these updates it will help bring additional development into the area.

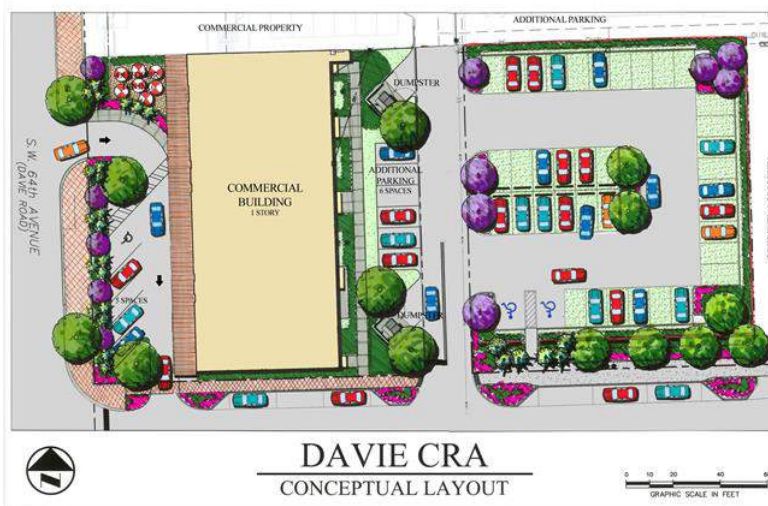



CRAVEN • THOMPSON & ASSOCIATES, INC.
Engineers • Planners • Surveyors • Landscape Architects

Roundabout - SW 136th Avenue and SW 14th Street, Davie, Florida

Client:

Mr. Mark Collins
Director of Public Works
Town of Davie
6591 Orange Drive
Davie, Florida 33314-3399
Phone: (954) 797-1245

Completion Date: 2009

Project Summary:

The Town of Davie constructed a roundabout at the intersection of SW 136th Avenue and SW 14th Street. This construction is part of several traffic calming projects that were undertaken by the Town. Craven Thompson & Associates, Inc. was the Design Engineer for this project.

The project involved roadway design, drainage design, pavement marking & signage and permitting through Broward County Highway and Construction Engineering Division, Broward County Traffic Engineering Division, CBWCD, and SFWMD.





Craven-Thompson & Associates, Inc.
Engineers • Planners • Surveyors • Landscape Architects

Westside Town Hall Drainage Study & Implementation, Davie, Florida

Client:

Mr. Giovanni Moss, Community Development Director
Town of Davie
4700 Davie Road, Suite D
Davie, Florida 33314
Phone: (954) 797-1173
Email: gmoss@davie-fl.gov

Contract Amount: \$168,240.00

Completion Date:

Study & Plans - May 2009 - 2011
Construction - 2016

Project Summary:

The Town of Davie Community Redevelopment Agency has completed the Westside Town Hall Drainage Study within the CRA, west of Davie Road and north of Orange Drive. The site is approximately thirty-four (33.79) acres and is bounded by S.W. 41st Court on the south, S.W. 67th Avenue on the west, S.W. 39th Street on the north, and Davie Road on the east. The Drainage Study incorporated a 5 acres parcel of Town owned land adjacent to the Central Broward Water Control District Canal west of Town Hall as a passive park/retention area to attenuate the storm water.

The Public Works site, West Side, Covenant House Park Site, North Side with Dry Retention, and the SW 67th Avenue Extension are all proposed to be interconnected with a storm drainage trunk line, and discharge to the CBWCD N-7 Canal via one (1) new control structure. The new control structure was placed in the dry retention area near the northern end of the Covenant House Park Site and has a 5.40-inch wide weir slot at invert elevation 3.55' NAVD to limit the discharge to the canal and provides the required water quality for the Public Works Site, Covenant House Park Site, and the West Side. The North Side has its own dry retention area for water quality and control structure with a weir elevation of 3.10' NAVD, prior to discharging to the main trunk line. The main storm sewer trunk line system for the area has been design and permitted by Craven Thompson & Associates, Inc.

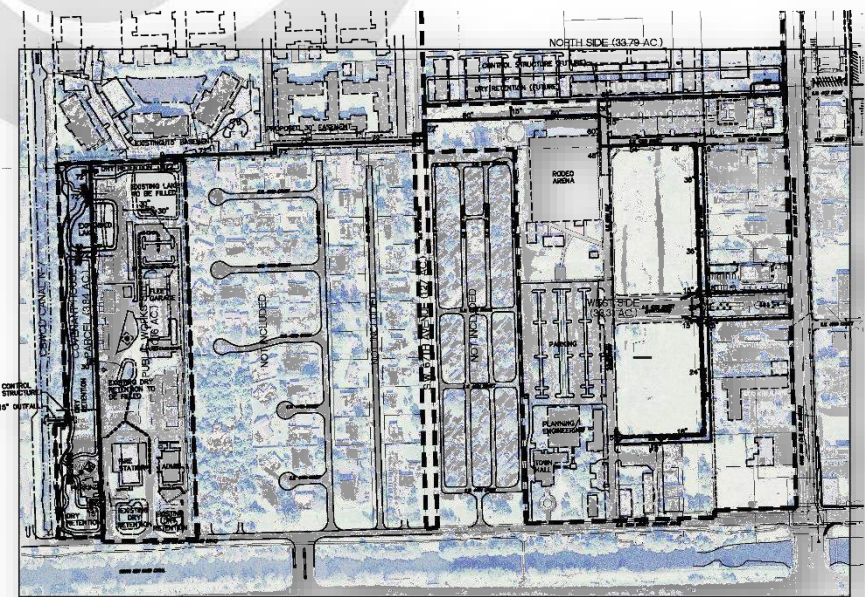



Craven Thompson & Associates, Inc.
Engineers • Planners • Surveyors • Landscape Architects

Roundabout - Hiatus Road and SW 26th Street, Davie, Florida

Client:

Mr. Mark Collins
Director of Public Works and Capital Projects
Town of Davie
6591 Orange Drive
Davie, Florida 33314-3399
Phone: (954) 797-1245
Email: mark_collins@davie-fl.gov

Estimated Construction Cost: \$320,000.00

Completion Date: 2008

Craven Thompson & Associates, Inc. was the Design Engineer for this project. The Town of Davie constructed roundabout at the intersection of Hiatus Road and S.W. 26th Street. This construction is part of several traffic calming projects undertaken by the Town.

The project involved roadway design, drainage design, pavement marking & signage and permitting through Broward County Highway and Construction Engineering Division, Broward County Traffic Engineering Division, CBWCD, and SFWMD.



TABI



CRAVEN-THOMPSON & ASSOCIATES, INC.
Engineers • Planners • Surveyors • Landscape Architects

OFFICE LOCATIONS

Below are the office locations of where services will be rendered by Craven Thompson & Associates and our sub-consultants, along with contact information and number of Professional and Administrative Personnel.

Craven Thompson & Associates, Inc.

3563 NW 53rd Street

Fort Lauderdale, Florida 33309

Phone No.: (954) 739-6400 / Facsimile No.: (954) 739-6409

Contact Person: Patrick J. Gibney, P.E., Principal-in-Charge | Vice President, Engineering

Email Address: pgibney@craventhompson.com

Professional Staff: 64, Administrative Staff: 11

BROWARD COUNTY LOCAL BUSINESS TAX RECEIPT
 115 S. Andrews Ave., Rm. A-100, Ft. Lauderdale, FL 33301-1895 – 954-831-4000
 VALID OCTOBER 1, 2016 THROUGH SEPTEMBER 30, 2017

DBA: **CRAVEN THOMPSON & ASSOCIATES** Receipt #: **315-657**
 Business Name: Business Type: **ENGINEER (CORP-ENGINEERING)**

Owner Name: **THOMAS M MCDONALD** Business Opened: **09/25/2006**
 Business Location: **3563 NW 53 ST** State/County/Cert/Reg: **0507-001228**
 FT LAUDERDALE Exemption Code:
 Business Phone: **954-739-6400**

Rooms	Seats	Employees	Machines	Professionals
		5		

Number of Machines:		For Vending Business Only				
Tax Amount	Transfer Fee	NSF Fee	Penalty	Prior Years	Collection Cost	Total Paid
30.00	0.00	0.00	0.00	0.00	0.00	30.00

THIS RECEIPT MUST BE POSTED CONSPICUOUSLY IN YOUR PLACE OF BUSINESS

THIS BECOMES A TAX RECEIPT This tax is levied for the privilege of doing business within Broward County and is non-regulatory in nature. You must meet all County and/or Municipality planning and zoning requirements. This Business Tax Receipt must be transferred when the business is sold, business name has changed or you have moved the business location. This receipt does not indicate that the business is legal or that it is in compliance with State or local laws and regulations.

WHEN VALIDATED

Mailing Address:
 THOMAS M MCDONALD
 3563 NW 53 ST
 FORT LAUDERDALE, FL 33309

Receipt #1CP-15-00010932
 Paid 07/12/2016 30.00

2016 - 2017

TAB J

Town of Davie
CEI For Davie Road Phase II Roadway Improvement Project (LAP)

SECTION 4.0 REQUIRED PRICE PROPOSAL SUBMITTAL FORM

Item _____ **Description** _____ **Price** _____

Bidder to submit spreadsheet/exhibit with breakdown of costs and position titles/hourly rates.

TOTAL PROPOSAL PRICE _____ \$ _____

TOTAL PROPOSAL PRICE IN WORDS _____

Bid Notes:

1. Must be FDOT pre-qualified to conduct CEI services.
2. Must have completed (3) three LAP Projects within the Tri-County Area and provide evidence of same in accordance with Section 3.7.

Authorized Signatory: _____



(Signature)

Executed by: Patrick J. Gibney, P.E.

(Type or print name)

Title: Vice President, Engineering

For (Company): Craven, Thompson & Associates, Inc.

Address: 3563 NW 53rd Street, Fort Lauderdale, Florida 33309

Telephone Number: (954) 739-6400 Fax Number: (954) 739-6409

Email: pgibney@craventhompson.com

The Bidder agrees to accept the Town of Davie's Visa procurement card for payment.

Circle one: YES OR **NO**

Town of Davie
CEI For Davie Road Phase II Roadway Improvement Project (LAP)

SECTION 5.0 TOWN REQUIRED FORMS

NON-COLLUSIVE AFFIDAVIT

STATE OF Florida
COUNTY OF Broward

Patrick J. Gibney, P.E. being first duly sworn deposes and says that:

BIDDER is the Officer
(Owner, Partner, Officer, Representative or Agent)

BIDDER is fully informed respecting the preparation and contents of the attached Bid and of all pertinent circumstances respecting such Bid;

Such Bid is genuine and is not a collusive or sham Bid;

Neither the said BIDDER nor any of its officers, partners, owners, agents, representative, employees or parties in interest, including this affidavit, have in any way colluded, conspired, connived or agreed, directly or indirectly, with any other BIDDER, firm or person to submit a collusive or sham Bid in connection with the Contract for which the attached Bid has been submitted; or to refrain from bidding in connection with such Contract; or have in any manner, directly or indirectly, sought by agreement or collusion, or communications, or conference with any BIDDER, firm, or person to fix the price or prices in the attached Bid or any other BIDDER, or to fix any overhead, profit, or cost element of the Bid Price or the Bid Price of any other BIDDER, or to secure through any collusion conspiracy, connivance, or unlawful agreement any advantage against (Recipient), or any person interested in the proposed Contract;

The price of items quoted in the attached Bid are fair and proper and are not tainted by collusion, conspiracy, connivance, or unlawful agreement on the part of the BIDDER or any other of its agents, representatives, owners, employees or parties in interest, including this affidavit.

By 

Subscribed and sworn to before me this 28th day of December, 2016.

Notary Public (Signature)
My Commission Expires: 3/23/2018



Town of Davie
CEI For Davie Road Phase II Roadway Improvement Project (LAP)



TOWN OF DAVIE
E-VERIFY FORM

Bid No: RFQ No. B-17-28

Project Description: Construction Engineering and Inspection Services

For Davie RD Phase II - Local Agency Program (LAP)

Vendor/Consultant acknowledges and agrees to utilize the U.S. Department of Homeland Security's E-Verify System to verify the employment eligibility of:

- (a) all persons employed by Vendor/Consultant to perform employment duties within Florida during the term of the contract; and
- (b) all persons (including SUBCONTRACTORS/SUBVENDORS) assigned by Vendor/Consultant to perform work pursuant to the contract with the Department. The Vendor/Consultant acknowledges and agrees that use of the U.S. Department of Homeland Security's E-Verify System during the term of the contract is a condition of the contract with the Town of Davie.

Company/Firm: Craven, Thompson & Associates, Inc.

Authorized Signature: 

Print Name Patrick J. Gibney, P.E.

Title: Vice President, Engineering

Date: December 28, 2016

Town of Davie
CEI For Davie Road Phase II Roadway Improvement Project (LAP)

CONFIRMATION OF DRUG-FREE WORKPLACE

In order to have a drug-free workplace program, a business shall:

Publish a statement notifying employees that the unlawful manufacture, distribution, dispensing, possession, or use of a controlled substance is prohibited in the workplace and specifying the actions that will be taken against employees for violations of such prohibitions.

Inform employees about the dangers of drug abuse in the workplace, the business's policy of maintaining a drug-free workplace, any available drug counseling, rehabilitation, and employee assistance programs, and the penalties that may be imposed upon employees for drug abuse violations.

Give each employee engaged in providing the commodities or Contractual services that are under Bid a copy of the statement specified in subsection (1).

In the statement specified in subsection (1), notify the employee that, as a condition of working on the commodities or Contractual services that are under bid, the employee will abide by the terms of the statement and will notify the employer of any conviction of, or plea of guilty or nolo contendere to, any violation of Chapter 893 or of any controlled substance law of the United States or any State, for a violation occurring in the workplace no later than five (5) days after the conviction.

Impose a sanction on, or require the satisfactory participation in a drug abuse assistance or rehabilitation program if such is available in the employee's community by, any employee who is so convicted.

Make a good faith effort to continue to maintain a drug-free workplace through implementation of this section.

A signed copy of your Drug-Free Workplace Policy must be attached to this signed copy and submitted with the Bid Documents.

As the person authorized to sign the statement, I certify that this firm complies fully with the above requirements.

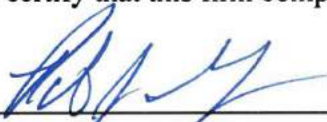

Patrick J. Gibney, P.E., Vice President, Engineering
Proposer's Signature

**Town of Davie
CEI For Davie Road Phase II Roadway Improvement Project (LAP)**

EMPLOYEE BACKGROUND VERIFICATION AFFIDAVIT

I, ***See below** _____, Company _____,

Attest that all personnel used in the performance of this work have had a criminal background check, and have no criminal offenses, a negative drug test result, and are legally documented to work in the United States.

The Town of Davie requests copies of the criminal back ground checks and drug test results.

Proposer's Signature _____

***Please note:**

Craven Thompson & Associates has not performed background checks on all employees; however, we would comply if required by the Town to provide background checks for all employees scheduled to work on the project.

Craven Thompson & Associates does perform drug testing on employees prior to employment and all Craven Thompson employees are legally documented to work in the United States.

Town of Davie
CEI For Davie Road Phase II Roadway Improvement Project (LAP)

ATTACHMENT "E"

Town of Davie
Vendor/Bidder Disclosure

I, Patrick J. Gibney, P.E., being first duly sworn state that: Craven, Thompson & Associates, Inc. The full legal name and business address of the person(s) or entity contracting with the Town of Davie ("Town") are as follows (Post Office addresses are not acceptable):

Name of Individual, Firm, or Organization:	<u>Craven, Thompson & Associates, Inc.</u>
Address:	<u>3563 NW 53rd Street</u>
	<u>Fort Lauderdale, Florida 33309</u>
FEIN	<u>59-0948029</u>
State and date of incorporation	<u>Florida, January 1, 1962</u>

OWNERSHIP DISCLOSURE AFFIDAVIT

1. If the contract or business transaction is with a corporation, the full legal name and business address shall be provided for each officer and director and each stockholder who directly or indirectly holds five percent (5%) or more of the corporation's stock. If the contract or business transaction is with a trust, the full name and address shall be provided for each trustee and each beneficiary. All such names and address are as follows (Post Office addresses are not acceptable):

Full Legal Name	Address	Ownership
<u>Thomas M. McDonald</u>	<u>3563 NW 53 St, Fort Lauderdale, FL 33309</u>	<u>100 %</u>
_____	_____	_____ %
_____	_____	_____ %
_____	_____	_____ %

2. The full legal names and business addresses of any other individual (other than subcontractors, suppliers, laborers, and lenders) who have, or will have, any legal, equitable, or beneficial interest

Town of Davie
CEI For Davie Road Phase II Roadway Improvement Project (LAP)

in the contract or business transaction with the Town are as follows (Post Office addresses are not acceptable):

Full Legal Name	Address
<u>None</u>	_____
_____	_____
_____	_____
_____	_____

By: 
Signature of Affiant
Patrick J. Gibney, P.E.
Print Name

Date: December 28, 2016

SUBSCRIBED AND SWORN TO or affirmed before me this 28th day of December 2016, by Patrick J. Gibney, P.E., he/she is personally known to me or has presented _____ as identification.

Notary Public, State of Florida at Large

PATRICIA A. GILBERT
Print or Stamp of Notary

My Commission Expires : 3/23/2018 Serial Number _____



Town of Davie
CEI For Davie Road Phase II Roadway Improvement Project (LAP)



Town of Davie
Local Vendor Preference

Affidavit of Eligibility

Complete all areas below. Incomplete forms may be rejected.

_____ My business is located within the Town of Davie.

LEGAL NAME OF FIRM: *** See Below** _____

Physical address:

Phone number _____ Fax number _____

Email address _____

Has the business name changed since it was opened in Davie? Yes _____ No _____

If Yes please provide the previous business name: _____

Taxpayer Identification Number: _____

Date your business was established in Town of Davie: _____

Business license: License number: _____ Date issued: _____

_____ A copy of my Business Tax Receipt is attached.

I employ _____ (insert a number) full time employees.

If your business is a Broward County business but not located within the Town of Davie please fill out the information on the next page.

***Please note: This Form is Not Applicable.**

Town of Davie
CEI For Davie Road Phase II Roadway Improvement Project (LAP)



Town of Davie
Local Vendor Preference
Broward County Vendor

Affidavit of Eligibility

Complete all areas below. Incomplete forms may be rejected.

My business is located within Broward County but not in the Town of Davie.

LEGAL NAME OF FIRM: Craven, Thompson & Associates, Inc.

Physical address: 3563 NW 53rd Street, Fort Lauderdale, Florida 33309

Phone number (954) 739-6400 Fax number (954) 739-6409

Email address pgibney@craventhompson.com

Has the business name changed since it was opened in Broward County? Yes No
Davis & Craven, Inc. (1/1/62 - 3/17/75)

If Yes please provide the previous business name: Davis, Craven, Thompson, Inc. (3/17/75 - 1/22/76)

Taxpayer Identification Number: 59-0948029

Date your business was established in Broward County: January 1, 1962

Business license: License number: 254407* Date issued: January 1, 1962

A copy of my Business Tax Receipt* is attached. ***Copy is located at the end of this Section.**

I employ 76 (insert a number) full time employees.

The undersigned states that the forgoing statements are true and correct. The undersigned also acknowledges that any person, firm, corporation or entity intentionally submitting false information to the Town in an attempt to qualify for local preference shall be prohibited from bidding on Town of Davie products and services for a period of one (1) year.

Town of Davie
CEI For Davie Road Phase II Roadway Improvement Project (LAP)

Authorized Signature: _____ Date: 12/28/2016

Printed Name & Title: Patrick J. Gibney, P.E., Vice President, Engineering

<p>Form W-9 (Rev. October 2007) Department of the Treasury Internal Revenue Service</p>	<p>Request for Taxpayer Identification Number and Certification</p>	<p>Give form to the requester. Do not send to the IRS.</p>
--	--	--

Print or type See Specific Instructions on page 2.	Name (as shown on your income tax return) Craven, Thompson & Associates, Inc.		
	Business name, if different from above		
	Check appropriate box: <input type="checkbox"/> Individual/Sole proprietor <input checked="" type="checkbox"/> Corporation <input type="checkbox"/> Partnership <input type="checkbox"/> Limited liability company. Enter the tax classification (D=disregarded entity, C=corporation, P=partnership) ◆ <input type="checkbox"/> Exempt payee <input type="checkbox"/> Other (see instructions) ◆		
	Address (number, street, and apt. or suite no.) 3563 NW 53rd Street	Requester's name and address (optional)	
	City, state, and ZIP code Fort Lauderdale, Florida 33309	List account number(s) here (optional)	

Part I Taxpayer Identification Number (TIN)

Enter your TIN in the appropriate box. The TIN provided must match the name given on Line 1 to avoid backup withholding. For individuals, this is your social security number (SSN). However, for a resident alien, sole proprietor, or disregarded entity, see the Part I instructions on page 3. For other entities, it is your employer identification number (EIN). If you do not have a number, see *How to get a TIN* on page 3.

Social security number _____
OR
Employer identification number 59 - 0948029

Note. If the account is in more than one name, see the chart on page 4 for guidelines on whose number to enter.

Part II Certification

Under penalties of perjury, I certify that:

1. The number shown on this form is my correct taxpayer identification number (or I am waiting for a number to be issued to me), and
2. I am not subject to backup withholding because: (a) I am exempt from backup withholding, or (b) I have not been notified by the Internal Revenue Service (IRS) that I am subject to backup withholding as a result of a failure to report all interest or dividends, or (c) the IRS has notified me that I am no longer subject to backup withholding, and
3. I am a U.S. citizen or other U.S. person (defined below).

Certification instructions. You must cross out item 2 above if you have been notified by the IRS that you are currently subject to backup withholding because you have failed to report all interest and dividends on your tax return. For real estate transactions, item 2 does not apply. For mortgage interest paid, acquisition or abandonment of secured property, cancellation of debt, contributions to an individual retirement arrangement (IRA), and generally, payments other than interest and dividends, you are not required to sign the Certification, but you must provide your correct TIN. See the instructions on page 4.

Sign Here	Signature of U.S. person ◆	Date ◆ December 28, 2016
------------------	----------------------------	---------------------------------

General Instructions

Section references are to the Internal Revenue Code unless otherwise noted.

Purpose of Form

A person who is required to file an information return with the IRS must obtain your correct taxpayer identification number (TIN) to report, for example, income paid to you, real estate transactions, mortgage interest you paid, acquisition or abandonment of secured property, cancellation of debt, or contributions you made to an IRA.

Use Form W-9 only if you are a U.S. person (including a resident alien), to provide your correct TIN to the person requesting it (the requester) and, when applicable, to:

1. Certify that the TIN you are giving is correct (or you are waiting for a number to be issued),
 2. Certify that you are not subject to backup withholding, or
 3. Claim exemption from backup withholding if you are a U.S. exempt payee. If applicable, you are also certifying that as a U.S. person, your allocable share of any partnership income from a U.S. trade or business is not subject to the withholding tax on foreign partners' share of effectively connected income.
- Note.** If a requester gives you a form other than Form W-9 to request your TIN, you must use the requester's form if it is substantially similar to this Form W-9.

LOBBYING INTEREST

Respondents should refer to Sec. 2-57 of the attached form for complete definition of terms.

I, Patrick J. Gibney, P.E. representing Craven, Thompson & Associates, Inc.
declare that I have read the attached form and that (check one):

My company is not interested in lobbying either staff or elected officials on any subject associated with this Request for Proposal (RFP)

My company is interested in lobbying either staff or elected officials on matters associated with this Request for Proposal (RFP). I understand that in order to lobby, I must fill out the attached form and submit it to the Town Clerk's Office along with a registration fee of \$50.00.

Title of RFP: Construction Engineering and Inspection Services for Davie RD Phase II - Local Agency Program (LAP)

Bidder Name: Craven Thompson & Associates, Inc.

Address: 3563 NW 53rd Street

Fort Lauderdale, Florida 33309

Phone Number: (954) 739-6400

Fax Number: (954) 739-6409

e-mail Address: pgibney@craventhompson.com

Signature: 

Print Name: Patrick J. Gibney, P.E.

LOBBYING INTEREST

Respondents should refer to Sec. 2-57 of the attached form for complete definition of terms.

I, Patrick J. Gibney, P.E. representing Craven Thompson declare that I have read the attached form and that (check one):

My company is not interested in lobbying either staff or elected officials on any subject associated with this Request For Proposal (RFP)

My company is interested in lobbying either staff or elected officials on matters associated with this Request For Proposal (RFP). I understand that in order to lobby, I must fill out the attached form and submit it to the Town Clerk's Office along with a registration fee of \$50.00.

Title of RFP: Construction Engineering and Inspection Services for Davie RD Phase II - Local Agency Program (LAP)

Bidder Name: Craven Thompson & Associates, Inc.

Address: 3563 NW 53rd Street
Fort Lauderdale, Florida 33309

Phone Number: (954) 739-6400

Fax Number: (954) 739-6409

Email Address: pgibney@craventhompson.com

Signature: 

Print Name: Patrick J. Gibney, P.E.

TOWN OF DAVIE LOBBYIST'S REGISTRATION STATEMENT AND OATH

Registration will be annual, from October 1st to September 30th, and shall be renewed for each year during which lobbying activities are to take place. Only one annual registration form is required. If, however, any of the information required on the registration form is new or changed (for example, a new principal, as defined by Section 2-57 of Ordinance 2012-17, or a new specific subject of lobbying), the Lobbyist must then supplement or amend the registration before additional lobbying. (Ordinance 2012-17, Section 2-58(d))

LOBBYIST INFORMATION (Ordinance 2012-17, Section 2-58(a)(1))

Name *** See Below** _____

Address _____

{must be a physical address (e.g. not a Post Office Box) where the lobbyist resides or customarily does business)

City _____ State _____ Zip _____ Telephone _____

Explain the nature and extent of any business, professional or familial relationship which the lobbyist, or any member of the lobbyist's immediate family, has had with any Town official, or member of the immediate family of any Town official within the period of time commencing twenty-four (24) months prior to registration.

Explain the nature and extent of any involvement, activity or assistance, whether paid or voluntary, by any lobbyist, or any member of the lobbyist's immediate family, with the current or the most recent campaign of any current elected Town official, or current candidate for Town Council. (2012-017, Section2-58(a)(3))

***Please Note: This form is Not Applicable - Craven Thompson & Associates, Inc. will not hire a Lobbyist.**

LOBBYIST'S PRINCIPAL(S) INFORMATION (Ordinance 2012-17, Section 2-58(a)(4))

Name ***See Below** _____

Address _____
(must be a physical address (e.g. not a Post Office Box) where the principal resides or customarily does business)

City _____ State Zip _____ Telephone _____

Explain the general and specific matters upon which the lobbyist intends to lobby, if known at the time of registration. *H not* known at time of filing, the registration must be supplemented when the matter is determined. (Ordinance 2012-017,Section 2-58(a)(5))

I hereby acknowledge that I have received a copy of Ordinance 2012-17, concerning registration of lobbyists and acknowledge that any violation of this Ordinance shall result in penalties as stated in said Ordinance. I further acknowledge that this form must be accompanied by payment in the amount of \$50 for each principal represented and by each lobbyist. (Ordinance 2012-17,Section 2-58(b))

I hereby attest and affirm under penalty of perjury, that the facts contained herein are true and correct. Further, I understand that I **am** required to notify the Town Clerk, in writing, of any changes to the information contained herein and that I **am** required to complete a lobbyist statement for each new principal or subject matter which occurs throughout the year.

Signature of Lobbyist

STATE OF FLORIDA) _____
) SS:
COUNTY OF)

Sworn to and subscribed before me this _____ day of _____ 20__ by _____ who is personally known to me or who has produced _____ as identification.

My Commission expires _____

Name _____ Signature _____

***Please Note: This form is Not Applicable - Craven Thompson & Associates, Inc. will not hire a Lobbyist.**

ACKNOWLEDGEMENT OF ADDENDA

INSTRUCTIONS: COMPLETE PART I OR PART II, WHICHEVER APPLIES

PART I:

LIST BELOW THE DATES OF ISSUE FOR EACH ADDENDUM RECEIVED IN CONNECTION WITH THIS RFP.

- Addendum #1, Dated December 12, 2016
- Addendum #2, Dated December 14, 2016
- Addendum #3, Dated December 19, 2016
- Addendum #4, Dated _____
- Addendum #5, Dated _____
- Addendum #6, Dated _____
- Addendum #7, Dated _____
- Addendum #8, Dated _____

PART II:

NO ADDENDUM WAS RECEIVED IN CONNECTION WITH THIS RFP.

FIRM NAME: Craven, Thompson & Associates, Inc.

AUTHORIZED SIGNATURE:  DATE: December 28, 2016
Patrick J. Gibney, P.E.

TITLE OF OFFICER: Vice President, Engineering



ADDENDUM TO BID DOCUMENTS

SOLICITATION RFP B-17-28 CONSTRUCTION ENGINEERING AND INSPECTION SERVICES FOR DAVIE RD
PHASE II – LOCAL AGENCY PROGRAM (LAP)

ADDENDUM No. 1 **BID OPENING DATE** 12/28/16 by 2:00 PM **TODAY'S DATE** 12/12/2016

To All Bidders:

This addendum is issued to modify the previously issued bid documents and/or given for informational purposes, and is hereby made a part of the bid documents. Please attach this addendum to the documents in your possession and acknowledge receipt of this addendum in the space provided on the bid form.

Attaching Exhibits herein:

- Construction bid document containing written specifications – Exhibit "A"
- Construction plans – Exhibit "B"

Reviewed by:

Purchasing Manager
Purchasing Division

Acknowledged by:
Craven, Thompson & Associates, Inc.
Contractor
Patrick J. Gibney, P.E.
Authorized Representative (Printed)
Vice President, Engineering
Title
Signature
December 28, 2016
Date



ADDENDUM TO BID DOCUMENTS

SOLICITATION	RFP B-17-28 CONSTRUCTION ENGINEERING AND INSPECTION SERVICES FOR DAVIE RD PHASE II – LOCAL AGENCY PROGRAM (LAP)		
ADDENDUM No.	<u>2</u>	BID OPENING DATE	<u>2:00 PM 12/28/16</u>
		TODAY'S DATE	<u>12/14/2016</u>

To All Bidders:

This addendum is issued to modify the previously issued bid documents and/or given for informational purposes, and is hereby made a part of the bid documents. Please attach this addendum to the documents in your possession and acknowledge receipt of this addendum in the space provided on the bid form.

A. Clarifications/Replacement Pages:

1. This solicitation shall be hereby referenced as a Request for Qualifications ("RFQ"); all references to "RFP" and "Bidder" shall be changed to "RFQ" and "Respondent", respectively.
2. Section Evaluation Criteria and Forms section has been updated accordingly. The following pages are hereby deleted and replaced as follows (~~strike through~~ represents language that has been deleted and underlined/bold represents added language):
 - a. Page 28 is hereby deleted and replaced with Page 28(a).
 - b. Page 29 is hereby deleted and replaced with Page 29(a).
 - c. Page 34 is hereby deleted and replaced with Page 34(a).
3. Project Team Form referenced in Section 3.7 has been attached to this addendum and is hereby included as a Required Form.

RESPONDENTS SHALL USE THE REPLACEMENT PAGES/NEW FORMS IN THEIR RESPONSES.

B. RFIs

1. **Question:** Please advise whether Section 1.5 PREPARATION OF BIDS is applicable to this advertisement. If so, please provide the "Bid Proposal Form" referenced therein.
Answer: Section 1.5 is not applicable.
2. **Question:** Section 1.13 allows questions up to 5 Days prior to bid opening, which would currently be 12/23, but the RFP states 12/21 as the last day. Please clarify.
Answer: The last day is 12/21 at 12:00 pm Noon EST.
3. **Question:** Please provide a copy of the LAP Agreement between FDOT and the Town of Davie.
Answer: The LAP agreement is attached to this addendum.
4. **Question:** What specific categories of pre-qualifications are required for the prime consultant?
Answer: 10.1, 10.4
5. **Question:** Will the Town of Davie be using the Local Preference grading per the RFP Sections 1.3 and 2.5 being that this is a federally funded project?
Answer: No, reference Section 1.3(c)(3).

Reviewed by:



Purchasing Manager
Purchasing Division

Acknowledged by: <u>Craven, Thompson & Associates, Inc.</u> Contractor <u>Patrick J. Gibney, P.E.</u> Authorized Representative (<i>Printed</i>) <u>Vice President, Engineering</u> Title  Signature <u>December 28, 2016</u> Date
--



ADDENDUM TO BID DOCUMENTS

SOLICITATION RFP B-17-28 CONSTRUCTION ENGINEERING AND INSPECTION SERVICES FOR DAVIE RD
PHASE II – LOCAL AGENCY PROGRAM (LAP)

ADDENDUM No. 3 **BID OPENING DATE** 12/28/16 by 2:00 PM **TODAY'S DATE** 12/19/2016

To All Bidders:

This addendum is issued to modify the previously issued bid documents and/or given for informational purposes, and is hereby made a part of the bid documents. Please attach this addendum to the documents in your possession and acknowledge receipt of this addendum in the space provided on the bid form.

RFI:

- 1. **Question:** Can the prime hold FDOT pre-qualification 10.1 and a sub-consultant hold 10.4 for this RFP?
Answer: Yes that is acceptable.

Reviewed by:

Purchasing Manager
Purchasing Division

Acknowledged by:
Craven, Thompson & Associates, Inc
Contractor
Patrick J. Gibney, P.E.
Authorized Representative (<i>Printed</i>)
Vice President, Engineering
Title
Signature
December 28, 2016
Date

PROPOSAL SIGNATURE PAGE FOR CORPORATION

The officers of the Corporation are as follows:

	<u>NAME</u>	<u>ADDRESS</u>
President	<u>Thomas M. McDonald, 3563 NW 53rd St., Fort Laud., FL 33309</u>	
Vice-President	<u>* See Below</u>	
Secretary	<u>Joseph D. Handley, R.L.A., 3563 NW 53rd St., Fort Laud., FL 33309</u>	
Treasurer	<u>Thomas M. McDonald, 3563 NW 53rd St., Fort Laud., FL 33309</u>	
Registered Agent	<u>None</u>	

The full names and residences of stockbrokers, persons, or firms interested in the foregoing Proposal, as principals, are as follows:

Same as above.

Post Office Address

PROPOSER:

Craven, Thompson & Associates, Inc.

(CORPORATE NAME)

tmcdonald@craventhompson.com

PRESIDENT'S SIGNATURE AND E-MAIL ADDRESS

Is this corporation incorporated in the State of Florida?

ATTEST: _____

SECRETARY Joseph D. Handley, R.L.A.

YES NO

If no, give address of principal place of business: _____

- * Patrick J. Gibney, P.E., Vice President, Engineering, 3563 NW 53rd St., Fort Laud., FL 33309
- Richard D. Pryce, P.S.M., V.P., Surveying & GIS, 3563 NW 53rd St., Fort Laud., FL 33309
- Joseph D. Handley, R.L.A., V.P., Planning & Landscape Arch., 3563 NW 53rd St., Fort Laud. 33309

PROPOSAL SIGNATURE PAGE FOR SOLE PROPRIETOR OR PARTNERSHIP

The full names and residences of persons, partners or firms interested in the foregoing Proposal, as principals, are as follows:

*** See Below**

PROPOSER

(FIRM NAME)

Witnesses:

(SEAL)

SIGNATURE AND E-MAIL ADDRESS

PRINT NAME

Title (Sole Proprietor or Partner)

Post Office Address:

TELEPHONE

CITY in which fictitious name is registered.

Attach a copy of proof of registration

***Please Note: This form is Not Applicable.**

SOLICITATION, GIVING, AND ACCEPTANCE OF GIFTS POLICY

Florida Statute 112.313 prohibits the solicitation or acceptance of Gifts. - "No Public officer, employee of an agency, or candidate for nomination or election shall solicit or accept anything of value to the recipient, including a gift, loan, reward, promise of future employment, favor, or service, based upon any understanding that the vote, official action, or judgment of the public officer, employee, or candidate would be influenced thereby."... The term 'public officer' includes any person elected or appointed to hold office in any agency, including any person serving on an advisory body."

The Town of Davie policy prohibits all public officers, elected or appointed, all employees, and their families from accepting any gifts of any value, either directly or indirectly, from any contractor, vendor, consultant, or business with whom the Town does business. Only advertising office stationery or supplies of small value are exempt from this policy - e.g. calendars, note pads, pencils.

The State of Florida definition of "gifts" includes the following:

- Real property or its use,
- Tangible or intangible personal property, or its use,
- A preferential rate of terms on a debt, loan, goods, or services,
- Forgiveness of indebtedness,
- Transportation, lodging, or parking,
- Membership dues,
- Entrance fees, admission fees, or tickets to events, performances, or facilities,
- Plants, flowers or floral arrangements

Services provided by persons pursuant to a professional license or certificate. Other personal services for which a fee is normally charged by the person providing the services. Any other similar service or thing having an attributable value not already provided for in this section. To this list, the Town of Davie has added food, meals, beverages, and candy.

Any contractor, vendor, consultant, or business found to have given a gift to a public officer or employee, or his/her family, will be subject to dismissal or revocation of contract.

As the person authorized to sign the statement, I certify that this firm will comply fully with this policy.

 _____ SIGNATURE	Patrick J. Gibney, P.E. _____ PRINTED NAME
Craven Thompson & Associates _____ NAME OF COMPANY	Vice President, Engineering _____ TITLE

Failure to sign this page shall render your bid non-responsive

Town of Davie

SOURCE OF INFORMATION

How did you find out about this solicitation? Check all that applies.

- 1. www.davie-fl.gov
- 2. www.demandstar.com
- 3. The Sun Sentinel
- 5. Referral/word-of-mouth Specify Source: _____
- 6. Search Engine/Internet search
- 7. E-mail, newsgroup, online chat Specify _____ Source: _____

- 8. Banner or Link on another website
- 9. Flyer, newsletter, direct mail Specify Source: _____
- Other Specify _____ Source: _____

Please note: This survey form is used for internal Procurement purposes only.

Town of Davie

INDEMNIFICATION CLAUSE

The Contractor shall indemnify, defend and hold harmless the Town Council, the Town of Davie and their agents and employees from and against all claims, damages, losses and expenses (including attorney's fees) arising out of or resulting from the contractor's performance of the work, provided that any such claim, damage, loss or expense (1) is attributable to bodily injury, sickness, disease or death, or to injury to or damage on destruction of property including the loss of use resulting there from, and (2) is caused in whole or in part by any breach or default by Contractor or negligent act or omission of the Contractor, any Subcontractor, anyone directly or indirectly employed by any of them or anyone for whose acts any of them may be liable, regardless or whether or not it is caused in part by a party indemnified hereunder.

Craven, Thompson & Assoc.  December 28, 2016
Proposer's Name Signature Date
Patrick J. Gibney, P.E.
Vice President, Engineering

STATE OF FLORIDA
COUNTY OF BROWARD

SWORN TO AND SUBSCRIBED before me, the under signed authority,

Patrick J. Gibney, P.E. who, after first being sworn by me, affixed his/her
[name of individual signing]
signature in the space provided above on this 28th day of December, 2016



NOTARY PUBLIC

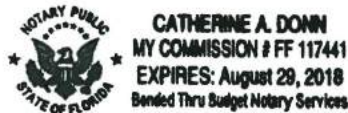

Town of Davie

SWORN STATEMENT PURSUANT TO SECTION 287.133 (3) (a), FLORIDA STATUTES, ON PUBLIC ENTITY CRIMES

THIS FORM MUST BE SIGNED AND SWORN TO IN THE PRESENCE OF A NOTARY PUBLIC OR OTHER OFFICIAL AUTHORIZED TO ADMINISTER OATHS.

1. This sworn statement is submitted to the **TOWN OF DAVIE, FLORIDA**

By: Patrick J. Gibney, P.E., Vice President, Engineering

(print individual's name and title)

For: Craven, Thompson & Associates, Inc.

(print name of entity submitting sworn statement)

whose business address is: 3563 NW 53rd Street, Fort Lauderdale, Florida 33309

and (if applicable) its Federal Employer Identification Number (FEIN) is: 59-0948029
(If the entity has no FEIN, include the Social Security Number of the individual signing this sworn statement: _____ - _____ - _____).

2. I understand that a "public entity crime" as defined in Paragraph 287.133 (1)(g), Florida Statutes, means a violation of any state or federal law by a person with respect to and directly related to the transaction of business with any public entity or with an agency or political subdivision of any other state or of the United States, including but not limited to, any bid or contract for goods or services to be provided to any public entity or an agency or political subdivision of any other state or of the United States and involving antitrust, fraud, theft, bribery, collusion, racketeering, conspiracy, or material misrepresentations.
3. I understand that "convicted" or "conviction" as defined in Paragraph 287.133 (1) (b), Florida Statutes, means a finding of guilt or a conviction of a public entity crime, with or without an adjudication of guilt, in any federal or state trial court of record relating to charges brought by indictment or information after July 1, 1989, as a result of a jury verdict, non-jury trial, or entry of a plea of guilty or non contendere.
4. I understand that an "affiliate" as defined in Paragraph 287.133(1)(a), Florida Statutes, means:
 1. A predecessor or successor of a person convicted of a public entity crime; or
 2. An entity under the control of any natural person who is active in the management of the entity and who has been convicted of a public entity crime. The term "affiliate" includes those officers' directors, executives, partners, shareholders, employees, members, and agents who are active in the management of an affiliate. The ownership by one person of shares constituting a controlling interest in another person, or a pooling of equipment or income among persons when not for fair market value under an arm's length agreement, shall be a prima facie case that one person controls another person. A person who knowingly enters into a joint venture with a person who has been convicted of a public entity crime in Florida during the preceding 36 months shall be considered an affiliate.
5. I understand that a "person" as defined in Paragraph 287.133(1) (e), Florida Statutes, means any natural person or entity organized under the laws of any state or of the United States with legal power to enter into a binding contract and which bids or applies to bid on contracts for the provision of goods or services let by a public entity, or which otherwise transacts or applies to transact business with a public entity. The term "person" includes those officers, directors, executives, and partners. Shareholders, employees, members, and agents who are active in management of an entity.
6. Based on information and belief, the statement, which I have marked below, is true in relations

Town of Davie

to the entity submitting this sworn statement. (Indicate which statement applies by CHECKING BOX BELOW).

- Neither the entity submitting this sworn statement, nor any of its officers, directors, executives, partners, shareholders, employees, members, or agents who are active in the management of the entity, nor any affiliate of the entity has been charged with and convicted of a public entity crime subsequent to July 1, 1989.
- The entity submitting this sworn statement, or one or more of its officers, directors, executives, partners, shareholders, employees, members, or agents who are active in the management of the entity, or an affiliate of the entity has been charged with and convicted of a public entity crime subsequent to July 1, 1989.
- The entity submitting this sworn statement, or one or more of its officers, directors, executives, partners, shareholders, employees, members, or agents who are active in the management of the entity, or an affiliate of the entity has been charged with and convicted of a public entity crime subsequent to July 1, 1989. However, there has been a subsequent proceeding before a Hearing Officer of the State of Florida, Division of Administrative Hearings and the final Order entered by the Hearing Officer determined that it was not in the public interest to place the entity submitting this sworn statement on the convicted vendor list (attach a copy of the final order).

I UNDERSTAND THAT THE SUBMISSION OF THIS FORM TO THE CONTRACTING OFFICER FOR THE PUBLIC ENTITY IDENTIFIED IN PARAGRAPH 1 ABOVE IS FOR THAT PUBLIC ENTITY ONLY AND THAT THIS FORM IS VALID THROUGH DECEMBER 31 OF THE CALENDAR YEAR IN WHICH IT IS FILED. I ALSO UNDERSTAND THAT I AM REQUIRED TO INFORM THE PUBLIC ENTITY PRIOR TO ENTERING INTO A CONTRACT IN EXCESS OF THE THRESHOLD AMOUNT PROVIDED IN SECTION 287.017, FLORIDA STATUTES FOR CATEGORY TWO OF ANY CHANGE IN THE INFORMATION CONTAINED IN THIS FORM.

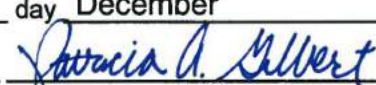

Patrick J. Gibney, P.E., Vice President, Engineering
Signature

Sworn to and subscribed before me this 28th day December, 2016
Personally known _____
OR _____
Produced identification _____

Name of Notary
Notary Public – State of FLORIDA



Town of Davie

ANTI-KICKBACK AFFIDAVIT

STATE OF FLORIDA }
 }
COUNTY OF BROWARD }

SS:

I, the undersigned, hereby duly sworn, depose and say that no portion of the sum herein bid will be paid to any employees of the Town of Davie, its elected officials, and Craven, Thompson & Associates or its design consultants, as a commission, kickback, reward or gift, directly or indirectly by me or any member of my firm or by an officer of the corporation.

Jennifer MacDonale
J. J. [Signature]

By: [Signature]
Patrick J. Gibney, P.E.

Title: Vice President, Engineering

Sworn and subscribed before this
28th day of December, 2016

Patricia A. Gilbert
Notary Public, State of Florida

PATRICIA A. GILBERT
(Printed Name)

My commission expires: 3/23/2018



Town of Davie

PROPOSER QUESTIONNAIRE

1. Today's Date:

December 28, 2016

2. Name of Company Submitting Proposal:

Craven, Thompson & Associates, Inc.

3. How many years has your firm been in business under its present business name?: 40 Years

4. Under what other former name(s) has your firm operated?: Davis & Craven, Inc.

(1/1/62 - 3/17/75), Davis, Craven, Thompson, Inc. (3/17/75 - 1/22/76)

5. Have any similar agreements held by proposer for a similar project to the proposed project ever been canceled? Circle one: No Yes If yes, please explain: _____

6. Has the proposer or any principals of the firm failed to qualify as a responsible proposer, refused to enter into a contract after an award has been made, failed to complete a contract during the past five (5) years, or been declared to be in default in any contract in the last five (5) years? Circle one: No Yes

If yes, please explain: _____

7. Has the proposer or any principals of the firm ever been declared bankrupt or reorganized under Chapter 11 or put into receivership? Circle one: No Yes

If yes, please explain and give date, court jurisdiction, action taken, and any other explanation deemed necessary: _____

8. Indicate registration, license numbers or certificate numbers for the businesses or professions, which are the subject of this BID. Please attach certificate of competency and/or State registration.

Engineering - License No. 271, Land Surveying - License No. LB271, Landscape Architecture - License No. LCC000114, Copies are located at the end of this Section.

9. List the pertinent experience of the key individuals of your firm (continue on insert sheet if necessary): Please refer to Tab G for Professional Resumes of Key Personnel.

Town of Davie

10. State the name and title of the individual who will have personal management of the work: Patrick J. Gibney, P.E., Vice President, Engineering

11. State the name and address of attorney, if any, for the firm: None

12. State the names and addresses of all businesses and/or individuals who own an interest of more than five percent (5%) of the Proposer's business and indicate the percentage owned of each such business and/or individual: Thomas M. McDonald, President - 100%
3563 NW 53rd Street, Fort Lauderdale, Florida 33309

13. State the names, addresses and the type of business of all firms that are partially or wholly owned by Proposer: Craven, Thompson & Associates, Inc., 3563 NW 53rd Street,
Fort Lauderdale, Florida 33309, Type of Business: Civil, Surveying, Planning,
Landscape Architecture, Construction Administration

14. Bank references:

<u>BANK NAME</u>	<u>ADDRESS (CITY, STATE, ZIP)</u>	<u>PHONE</u>
<u>Legacy Bank of Florida - Account No. 0040005449</u>	<u>Relationship Manager, Ms. Golden Johansson - (954) 763-5550.</u>	
<u>12 Southeast 7th Street, Suite 100, Fort Lauderdale, Florida 33301</u>		

15. Firm has attached a current Certificate of Liability Insurance? Yes No

16. Litigation/Judgements/Settlements/Debarments/Suspensions – Submit information on any pending litigation and any judgements and settlements of court cases relative to providing the services requested herein that have occurred within the last three (3) years. Also indicate if your firm has been debarred or suspended from bidding or proposing on a procurement project by any government entity during the last five (5) years. _____

A List of Litigation within the last three (3) years is included in this section.
Craven Thompson & Associates has not been debarred or suspended from
bidding or proposing on a procurement project by any government entity during
the last five (5) years.

17. Disclosure of Conflict of Interest

VENDOR SHALL DISCLOSE BELOW, TO THE BEST OF HIS OR HER KNOWLEDGE, ANY TOWN OF DAVIE OFFICER OR EMPLOYEE, OR ANY RELATIVE OF ANY SUCH OFFICER OR EMPLOYEE AS DEFINED IN SECTION 112.3135, FLORIDA STATUTES, WHO IS AN OFFICER, PARTNER, DIRECTOR OR PROPRIETOR OF, OR HAS A MATERIAL INTEREST IN THE VENDOR'S BUSINESS OR ITS PARENT COMPANY, ANY SUBSIDIARY, OR AFFILIATED COMPANY, WHETHER SUCH TOWN OFFICIAL OR EMPLOYEE IS IN A POSITION TO INFLUENCE THIS PROCUREMENT OR NOT.

Town of Davie

Name Relationship
None

Craven, Thompson & Associates, Inc.
FIRM NAME

SIGNATURE OF AUTHORIZED AGENT

Patrick J. Gibney, P.E., Vice President, Engineering
NAME & TITLE, TYPED OR PRINTED

STATE OF Florida)
COUNTY OF Broward) SS

The foregoing instrument was sworn to and subscribed before me this 28th day of December, 2016 by Patrick J. Gibney, P.E. who is personally known to me or produced as identification.

Patricia A. Gilbert
NOTARY PUBLIC, State of FLORIDA
Print Name: PATRICIA A. GILBERT

Commission No.:
Commission Expires: 3/23/2018

SEAL
(if Corporation)



6.0 LAP REQUIRED FORMS

STATE OF FLORIDA DEPARTMENT OF TRANSPORTATION
TRUTH IN NEGOTIATION CERTIFICATION

375-030-30
PROCUREMENT
05/14

Pursuant to Section 287.055(5)(a), Florida Statutes, for any lump-sum or cost-plus-a-fixed fee professional services contract over the threshold amount provided in Section 287.017, Florida Statutes for CATEGORY FOUR, the Department of Transportation (Department) requires the Consultant to execute this certificate and include it with the submittal of the Technical Proposal, or as prescribed in the contract advertisement.

The Consultant hereby certifies, covenants, and warrants that wage rates and other factual unit costs supporting the compensation for this project's agreement are accurate, complete, and current at the time of contracting.

The Consultant further agrees that the original agreement price and any additions thereto shall be adjusted to exclude any significant sums by which the Department determines the agreement price was increased due to inaccurate, incomplete, or noncurrent wage rates and other factual unit costs. All such agreement adjustments shall be made within (1) year following the end of the contract. For purposes of this certificate, the end of the agreement shall be deemed to be the date of final billing or acceptance of the work by the Department, whichever is later.

Craven, Thompson & Associates, Inc.

Name of Consultant

By: _____

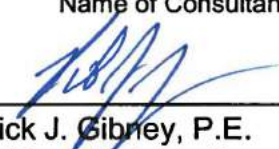
Patrick J. Gibrey, P.E.
Vice President, Engineering

December 28, 2016

Date

STATE OF FLORIDA DEPARTMENT OF TRANSPORTATION
**CONFLICT OF INTEREST CERTIFICATION
FOR CONSULTANT/CONTRACTOR**

375-030-50
PROCUREMENT
01/12

I certify that I have no present conflict of interest, that I have no knowledge of any conflict of interest that my firm may have, and that I will recuse myself from any capacity of decision making, approval, disapproval, or recommendation on any contract if I have a conflict of interest or a potential conflict of interest.

Consultants/Contractors are expected to safeguard their ability to make objective, fair, and impartial decisions when performing work for the Department, and therefore may not accept benefits of any sort under circumstances in which it could be inferred by a reasonable observer that the benefit was intended to influence a pending or future decision of theirs, or to reward a past decision. Consultants performing work for the Department should avoid any conduct (whether in the context of business, financial, or social relationships) which might undermine the public trust, whether or not that conduct is unethical or lends itself to the appearance of ethical impropriety.

I realize that violation of the above mentioned standards could result in the termination of my work for the Department.

Contract No./Project Description(s): Construction Engineering and Inspection Services for Davie Road
Phase II - Local Agency Program (LAP)

Financial Project Number(s): RFQ No. B-17-28

Each undersigned individual hereby attests that he/she has no conflicts of interest related to the contract(s) identified above.

Printed Names

Signatures

Date

Thomas M. McDonald
Patrick J. Gibney, P.E.
Richard D. Pryce, P.S.M.
Joseph D. Handley, R.L.A.

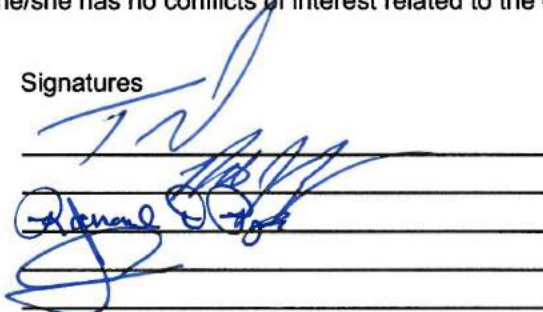

12-22-2016
12-22-2016
12-22-2016
12-22-2016

STATE OF FLORIDA DEPARTMENT OF TRANSPORTATION
**CERTIFICATION REGARDING DEBARMENT, SUSPENSION,
INELIGIBILITY AND VOLUNTARY EXCLUSION FOR FEDERAL
AID CONTRACTS**
(Compliance with 49CFR, Section 29.510)
(Appendix B Certification]

375-030-32
PROCUREMENT
10/01

It is certified that neither the below identified firm nor its principals are presently suspended, proposed for debarment, declared ineligible, or voluntarily excluded from participation in this transaction by any federal department or agency.

Name of Consultant:

By  Patrick J. Gibney, P.E. Date: 12/28/2016
Authorized Signature

Title: Vice President, Engineering

Instructions for Certification

1. By signing and submitting this certification with the proposal, the prospective lower tier participant is providing the certification set out below.
2. The certification in this clause is a material representation of fact upon which reliance was placed when this transaction was entered into. If it is later determined that the prospective lower tier participant knowingly rendered an erroneous certification, in addition to other remedies available to the Federal Government, the Department may pursue available remedies, including suspension and/or debarment.
3. The prospective lower tier participant shall provide immediate written notice to the person to which this proposal is submitted. If at any time the prospective lower tier participant learns that its certification was erroneous when submitted or has become erroneous by reason of changed circumstances.
4. The terms 'covered transaction', 'debarred', 'suspended', 'ineligible', 'lower tier covered transaction', 'participant', 'person', 'primary covered transaction', 'principal', 'proposal', and 'voluntarily excluded', as used in this clause, have the meanings set out in the Definitions and Coverage sections of the rules implementing Executive Order 12549. You may contact the person to which this proposal is being submitted for assistance in obtaining a copy of those regulations.
5. The prospective lower tier participant agrees by submitting this proposal that, should the proposed covered transaction be entered into, it shall not knowingly enter into any lower tier covered transaction with a person who is debarred, suspended, declared ineligible, or voluntarily excluded from participation in this covered transaction, unless authorized by the Department or agency with which this transaction originated.
6. The prospective lower tier participant further agrees by submitting this proposal that it will include this clause titled "Appendix B: Certification Regarding Debarment, Suspension, Ineligibility and Voluntary Exclusion - Lower Tier Covered Transaction", without modification, in all lower tier covered transactions and in all solicitations for lower tier covered transactions.
7. A participant in a covered transaction may rely upon a certification of a prospective participant in a lower tier covered transaction that it is not debarred, suspended, ineligible, or voluntarily excluded from the covered transaction, unless it knows that the certification is erroneous. A participant may decide the method and frequency by which it determines the eligibility of its principals. Each participant may, but is not required to, check the Nonprocurement List.
8. Nothing contained in the foregoing shall be construed to require establishment of a system of records in order to render in good faith the certification required by this clause. The knowledge and information of a participant are not required to exceed that which is normally possessed by a prudent person in the ordinary course of business dealings.
9. Except for transactions authorized under paragraph 5 of these instructions, if a participant in a covered transaction knowingly enters into a lower tier covered transaction with a person who is suspended, debarred, ineligible, or voluntarily excluded from participation in this transaction, in addition to other remedies available to the Federal Government, the Department may pursue available remedies, including suspension and/or debarment.

STATE OF FLORIDA DEPARTMENT OF TRANSPORTATION
**CERTIFICATION FOR DISCLOSURE OF LOBBYING ACTIVITIES
ON FEDERAL-AID CONTRACTS**
(Compliance with 49CFR, Section 20.100 (b))

375-030-33
PROCUREMENT
10/01

The prospective participant certifies, by signing this certification, that to the best of his or her knowledge and belief:

(1) No federal appropriated funds have been paid or will be paid, by or on behalf of the undersigned, to any person for influencing or attempting to influence an officer or employee of any federal agency, a Member of Congress, an officer or employee of Congress, or an employee of a Member of Congress in connection with the awarding of any federal contract, the making of any federal grant, the making of any federal loan, the entering into of any cooperative agreement, and the extension, continuation, renewal, amendment, or modification of any federal contract, grant, loan, or cooperative agreement.

(2) If any funds other than federal appropriated funds have been paid or will be paid to any person for influencing or attempting to influence an officer or employee of any federal agency, a Member of Congress, an officer or employee of Congress, or an employee of a Member of Congress in connection with this federal contract, grant, loan, or cooperative agreement, the undersigned shall complete and submit Standard Form-LLL, "Disclosure of Lobbying Activities", in accordance with its instructions. (Standard Form-LLL can be obtained from the Florida Department of Transportation's Professional Services Administrator or Procurement Office.)

This certification is a material representation of fact upon which reliance was placed when this transaction was made or entered into. Submission of this certification is a prerequisite for making or entering into this transaction imposed by Section 1352, Title 31, U.S. Code. Any person who fails to file the required certification shall be subject to a civil penalty of not less than \$10,000 and not more than \$100,000 for each such failure.

The prospective participant also agrees by submitting his or her proposal that he or she shall require that the language of this certification be included in all lower tier subcontracts, which exceed \$100,000 and that all such subrecipients shall certify and disclose accordingly.

Name of Consultant: Craven, Thompson & Associates, Inc.

By: Patrick J. Gibney, P.E. Date: 12/28/2016

Authorized Signature:  _____

Title: Vice President, Engineering



CRAVEN-THOMPSON & ASSOCIATES, INC.
Engineers • Planners • Surveyors • Landscape Architects

TAB J - REQUIRED FORMS

TOWN OF DAVIE - REQUEST FOR QUALIFICATIONS NO. B-17-28

PROFESSIONAL LICENSES / CORPORATE CHARTER

CRAVEN THOMPSON & ASSOCIATES, INC.

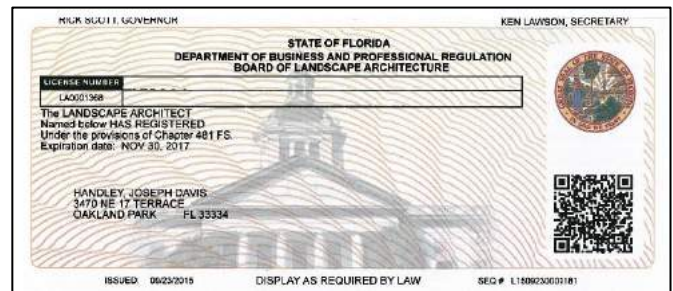
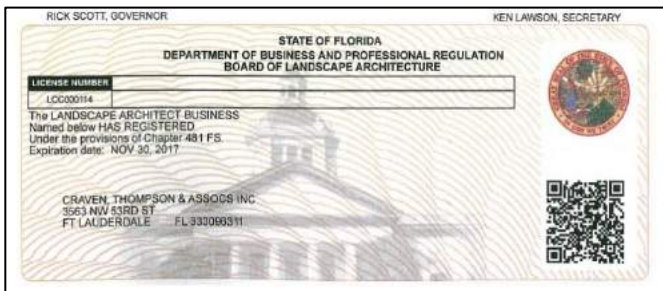
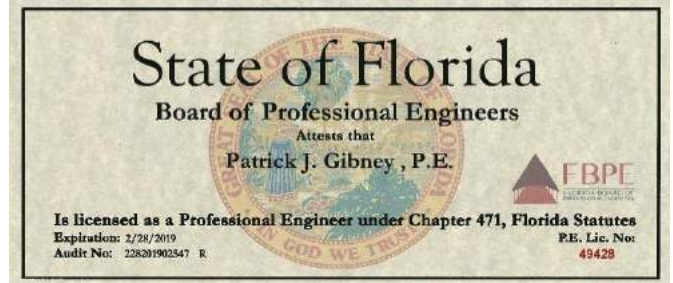

**State of Florida
Department of State**

I certify from the records of this office that CRAVEN, THOMPSON & ASSOCIATES, INC. is a corporation organized under the laws of the State of Florida, filed on January 1, 1962.

The document number of this corporation is 254407.

I further certify that said corporation has paid all fees due this office through December 31, 2016, that its most recent annual report/uniform business report was filed on January 22, 2016, and that its status is active.

I further certify that said corporation has not filed Articles of Dissolution.

Given under my hand and the Great Seal of the State of Florida at Tallahassee, the Capital, this the Twenty-second day of January, 2016

Secretary of State



Tracking Number: CC7285945249

To authenticate this certificate visit the following site, enter this number, and then follow the instructions displayed.

<https://services.sunbiz.org/Filings/CertificateOfStatus/CertificateAuthentication>



CRAVEN-THOMPSON & ASSOCIATES, INC.
Engineers • Planners • Surveyors • Landscape Architects

MARLIN ENGINEERING, INC.

State of Florida
Board of Professional Engineers
Attests that
Marlin Engineering Inc.



is authorized under the provisions of Section 471.023, Florida Statutes, to offer engineering services to the public through a Professional Engineer, duly licensed under Chapter 471, Florida Statutes.
Expiration: 2/28/2017
Audit No: 228211701889

CA Lic. No:
6104

State of Florida
Department of State

I certify from the records of this office that MARLIN ENGINEERING, INC. is a corporation organized under the laws of the State of Florida, filed on August 21, 1991.

The document number of this corporation is S74791.

I further certify that said corporation has paid all fees due this office through December 31, 2016, that its most recent annual report/uniform business report was filed on April 28, 2016, and that its status is active.

I further certify that said corporation has not filed Articles of Dissolution.

*Given under my hand and the
Great Seal of the State of Florida
at Tallahassee, the Capital, this
the Twenty-eighth day of April,
2016*



Ken Detmer
Secretary of State

Tracking Number: CC9206642404

To authenticate this certificate, visit the following site, enter this number, and then follow the instructions displayed.

<https://services.sunbiz.org/Filings/CertificateOfStatus/CertificateAuthentication>



Craven-Thompson & Associates, Inc.
 Engineers • Planners • Surveyors • Landscape Architects

PROGRESSIVE DESIGN AND ENGINEERING, INC..



2016 FLORIDA PROFIT CORPORATION ANNUAL REPORT

DOCUMENT# P9400072247

Entity Name: PROGRESSIVE DESIGN & ENGINEERING, INC.

Current Principal Place of Business:

10891 LA REINA RD
 SUITE 100
 DELRAY BEACH, FL 33446

Current Mailing Address:

10891 LA REINA RD
 SUITE 100
 DELRAY BEACH, FL 33446

FEI Number: 65-0523642

Certificate of Status Desired: No

Name and Address of Current Registered Agent:

MAJDALAWI, KAREN PST
 10891 LA REINA RD
 SUITE 100
 DELRAY BEACH, FL 33446 US

The above named entity submits this statement for the purpose of changing its registered office or registered agent, or both, in the State of Florida.

SIGNATURE:

Electronic Signature of Registered Agent

Date

Officer/Director Detail :

Title	PST	Title	VP
Name	MAJDALAWI, KAREN	Name	HOYOS, RODOLFO
Address	10891 LA REINA RD	Address	14011 LAKE GEORGE CT
City-State-Zip:	DELRAY BEACH FL 33446	City-State-Zip:	MIAMI FL 33014
Title	T	Title	S
Name	MAJDALAWI, WAEL	Name	ROBESON, GARY
Address	10891 LA REINA RD	Address	7420 LUGANO DRIVE
City-State-Zip:	DELRAY BEACH FL 33446	City-State-Zip:	BOYNTON BEACH FL 33437

I hereby certify that the information indicated on this report or supplemental report is true and accurate and that my electronic signature shall have the same legal effect as if made under oath; that I am an officer or director of the corporation or the receiver or trustee empowered to execute this report as required by Chapter 807, Florida Statute; and that my name appears above, or on an attachment to this report, as empowered.

SIGNATURE: KAREN MAJDALAWI

PRESIDENT

02/23/2016

Electronic Signature of Signing Officer/Director Detail

Date



Craven-Thompson & Associates, Inc.
Engineers • Planners • Surveyors • Landscape Architects

TAB J - REQUIRED FORMS

TOWN OF DAVIE - REQUEST FOR QUALIFICATIONS NO. B-17-28

INSURANCE CERTIFICATION



CERTIFICATE OF LIABILITY INSURANCE

DATE (MM/DD/YYYY)
 11/28/2016

THIS CERTIFICATE IS ISSUED AS A MATTER OF INFORMATION ONLY AND CONFERS NO RIGHTS UPON THE CERTIFICATE HOLDER. THIS CERTIFICATE DOES NOT AFFIRMATIVELY OR NEGATIVELY AMEND, EXTEND OR ALTER THE COVERAGE AFFORDED BY THE POLICIES BELOW. THIS CERTIFICATE OF INSURANCE DOES NOT CONSTITUTE A CONTRACT BETWEEN THE ISSUING INSURER(S), AUTHORIZED REPRESENTATIVE OR PRODUCER, AND THE CERTIFICATE HOLDER.

IMPORTANT: If the certificate holder is an ADDITIONAL INSURED, the policy(ies) must be endorsed. If SUBROGATION IS WAIVED, subject to the terms and conditions of the policy, certain policies may require an endorsement. A statement on this certificate does not confer rights to the certificate holder in lieu of such endorsement(s).

PRODUCER Corporate Insurance Advisors 1401 E Broward Blvd Suite 103 Ft. Lauderdale FL 33301	CONTACT NAME: Angela Nervi-Saketkoo PHONE (A/C, No, Ext): (954) 315-5000 FAX (A/C, No): (954) 315-5050 E-MAIL ADDRESS: ANervi@ciafl.net														
INSURED Craven Thompson & Associates, Inc. 3563 NW 53rd Street Fort Lauderdale FL 33309	<table border="1" style="width: 100%; border-collapse: collapse;"> <thead> <tr> <th style="text-align: left;">INSURER(S) AFFORDING COVERAGE</th> <th style="text-align: left;">NAIC #</th> </tr> </thead> <tbody> <tr> <td>INSURER A: Hartford Fire Insurance Co.</td> <td>19682</td> </tr> <tr> <td>INSURER B: Trumbull Insurance Co.</td> <td>27120</td> </tr> <tr> <td>INSURER C: Hartford Casualty Insurance Company</td> <td>29424</td> </tr> <tr> <td>INSURER D: Hartford Ins Co of the Southea</td> <td>38261</td> </tr> <tr> <td>INSURER E: Hanover Insurance Company</td> <td>22292</td> </tr> <tr> <td>INSURER F:</td> <td></td> </tr> </tbody> </table>	INSURER(S) AFFORDING COVERAGE	NAIC #	INSURER A: Hartford Fire Insurance Co.	19682	INSURER B: Trumbull Insurance Co.	27120	INSURER C: Hartford Casualty Insurance Company	29424	INSURER D: Hartford Ins Co of the Southea	38261	INSURER E: Hanover Insurance Company	22292	INSURER F:	
INSURER(S) AFFORDING COVERAGE	NAIC #														
INSURER A: Hartford Fire Insurance Co.	19682														
INSURER B: Trumbull Insurance Co.	27120														
INSURER C: Hartford Casualty Insurance Company	29424														
INSURER D: Hartford Ins Co of the Southea	38261														
INSURER E: Hanover Insurance Company	22292														
INSURER F:															

COVERAGES **CERTIFICATE NUMBER: 2017-2018** **REVISION NUMBER:**

THIS IS TO CERTIFY THAT THE POLICIES OF INSURANCE LISTED BELOW HAVE BEEN ISSUED TO THE INSURED NAMED ABOVE FOR THE POLICY PERIOD INDICATED. NOTWITHSTANDING ANY REQUIREMENT, TERM OR CONDITION OF ANY CONTRACT OR OTHER DOCUMENT WITH RESPECT TO WHICH THIS CERTIFICATE MAY BE ISSUED OR MAY PERTAIN, THE INSURANCE AFFORDED BY THE POLICIES DESCRIBED HEREIN IS SUBJECT TO ALL THE TERMS, EXCLUSIONS AND CONDITIONS OF SUCH POLICIES. LIMITS SHOWN MAY HAVE BEEN REDUCED BY PAID CLAIMS.

INSR LTR	TYPE OF INSURANCE	ADDL SUBR INSD. WVD	POLICY NUMBER	POLICY EFF (MM/DD/YYYY)	POLICY EXP (MM/DD/YYYY)	LIMITS												
A	<input checked="" type="checkbox"/> COMMERCIAL GENERAL LIABILITY CLAIMS-MADE <input checked="" type="checkbox"/> OCCUR GEN'L AGGREGATE LIMIT APPLIES PER: <input checked="" type="checkbox"/> POLICY <input type="checkbox"/> PRO-JECT <input type="checkbox"/> LOC OTHER:		21UUNZP1507	12/1/2016	12/1/2017	EACH OCCURRENCE \$ 1,000,000 DAMAGE TO RENTED PREMISES (Ea occurrence) \$ 300,000 MED EXP (Any one person) \$ 10,000 PERSONAL & ADV INJURY \$ 1,000,000 GENERAL AGGREGATE \$ 2,000,000 PRODUCTS - COMP/OP AGG \$ 2,000,000 Employee Benefits \$ 1,000,000												
B	<input checked="" type="checkbox"/> AUTOMOBILE LIABILITY ANY AUTO <input type="checkbox"/> SCHEDULED AUTOS ALL OWNED AUTOS <input type="checkbox"/> NON-OWNED AUTOS HIRED AUTOS <input type="checkbox"/>		21UENH8989	12/1/2016	12/1/2017	COMBINED SINGLE LIMIT (Ea accident) \$ 1,000,000 BODILY INJURY (Per person) \$ BODILY INJURY (Per accident) \$ PROPERTY DAMAGE (Per accident) \$ Uninsured motorist property \$												
C	<input checked="" type="checkbox"/> UMBRELLA LIAB <input type="checkbox"/> OCCUR <input checked="" type="checkbox"/> EXCESS LIAB <input type="checkbox"/> CLAIMS-MADE DED <input checked="" type="checkbox"/> RETENTIONS 10,000		21XRU&P1253	12/1/2016	12/1/2017	EACH OCCURRENCE \$ 5,000,000 AGGREGATE \$ 5,000,000												
D	WORKERS COMPENSATION AND EMPLOYERS' LIABILITY. ANY PROPRIETOR/PARTNER/EXECUTIVE OFFICER/MEMBER EXCLUDED? (Mandatory in NH) If yes, describe under DESCRIPTION OF OPERATIONS below	Y/N N/A	21WBAS2828	1/1/2017	1/1/2018	<table border="1" style="width: 100%; border-collapse: collapse;"> <thead> <tr> <th style="width: 5%;">PER STATUTE</th> <th style="width: 5%;">OTH-ER</th> <th style="width: 90%;">LIMITS</th> </tr> </thead> <tbody> <tr> <td></td> <td></td> <td>E.L. EACH ACCIDENT \$ 1,000,000</td> </tr> <tr> <td></td> <td></td> <td>E.L. DISEASE - EA EMPLOYEE \$ 1,000,000</td> </tr> <tr> <td></td> <td></td> <td>E.L. DISEASE - POLICY LIMIT \$ 1,000,000</td> </tr> </tbody> </table>	PER STATUTE	OTH-ER	LIMITS			E.L. EACH ACCIDENT \$ 1,000,000			E.L. DISEASE - EA EMPLOYEE \$ 1,000,000			E.L. DISEASE - POLICY LIMIT \$ 1,000,000
PER STATUTE	OTH-ER	LIMITS																
		E.L. EACH ACCIDENT \$ 1,000,000																
		E.L. DISEASE - EA EMPLOYEE \$ 1,000,000																
		E.L. DISEASE - POLICY LIMIT \$ 1,000,000																
E	Professional Liability \$50,000 Ded		LHJ A591180 01	3/30/2016	3/30/2017	Each Claim \$2,000,000 Aggregate \$4,000,000												

DESCRIPTION OF OPERATIONS / LOCATIONS / VEHICLES (ACORD 101, Additional Remarks Schedule, may be attached if more space is required)

CERTIFICATE HOLDER

 For Proposals Purposes Only

CANCELLATION

 SHOULD ANY OF THE ABOVE DESCRIBED POLICIES BE CANCELLED BEFORE THE EXPIRATION DATE THEREOF, NOTICE WILL BE DELIVERED IN ACCORDANCE WITH THE POLICY PROVISIONS.

 AUTHORIZED REPRESENTATIVE

 Mark Schwartz/ANGELA *Mark R. Schwartz*

© 1988-2014 ACORD CORPORATION. All rights reserved.

ACORD 25 (2014/01) The ACORD name and logo are registered marks of ACORD
 INS025 (201401)



LITIGATION

The following is a list of litigation matters in the past three years involving projects of a similar nature, which **Craven Thompson & Associates, Inc.** (CTA) has been involved in, and the resolution of the filing:

Date: Case filed June 4, 2013 / Dismissed February 2015 **Monetary Amount Involved:** None.

Case No.: Palm Beach County Case No. 502013CA007785XXXXMBAJ

Name of Case: The Edge No. One Condominium Association, Inc. vs. The Edge Investors, L.P.; Coastal Construction of South Florida, Inc.; Trans Coastal Construction Company; Steven Feller, P.E., P.L.; Cohen, Freedman, Encinosa & Associates-Architects, P.A.; CHM Consulting Engineers, Inc.; Craven Thompson & Associates, Inc.

Explanation: Plaintiff claimed unspecified problems with the building. It was unclear what civil engineering issues were relevant. The contractor, architect and the entire design team were defendants.

Date: Case filed June 9, 2015 / Settled December 9, 2016

Monetary Amount Involved: \$150,000 (Giannetti Contracting - \$120,000, Craven Thompson - \$30,000)

Case No.: Broward County Case No. 14-002381 (21)

Name of Case: Randy Ezekowitz vs. Giannetti Contracting Corporation, E&N Construction, Inc., Asphalt Milling Services, Inc., Bon's Barricades, Inc., Florida Department of Transportation, Craven Thompson & Associates, Inc. and Transfield Services Infrastructure, Inc.

Explanation: Plaintiff claims that CTA failed to warn motorists of the difference in elevation of pavement. Plaintiff did not specify a specific claim related to Civil Engineering.



CRAVEN-THOMPSON & ASSOCIATES, INC.
Engineers • Planners • Surveyors • Landscape Architects

BUSINESS TAX RECEIPTS

	<p>CITY OF FORT LAUDERDALE BUSINESS TAX YEAR 2016-2017</p> <hr/> <p>BUSINESS TAX DIVISION 100 N. ANDREWS AVENUE, 1ST FLOOR, FORT LAUDERDALE, FLORIDA 33301 (954) 828-5195</p>
<p>1301193 Business ID: 3563 NW 53 ST Business Address: ENGINEER Tax Category:</p>	<p>GIBNEY, PATRICK Business Name: 740068 Tax#: Fee: GIBNEY, PATRICK CRAVEN THOMPSON & ASSOCIATES 3563 NW 53 ST FORT LAUDERDALE, FL 33309</p>
DETACH AND POST THIS RECEIPT IN A CONSPICUOUS PLACE	

BROWARD COUNTY LOCAL BUSINESS TAX RECEIPT
115 S. Andrews Ave., Rm. A-100, Ft. Lauderdale, FL 33301-1895 – 954-831-4000
VALID OCTOBER 1, 2016 THROUGH SEPTEMBER 30, 2017

DBA: CRAVEN THOMPSON & ASSOCIATES	Receipt #: 315-657 ENGINEER (CORP-ENGINEERING)
Business Name: CRAVEN THOMPSON & ASSOCIATES	Business Type: ENGINEER (CORP-ENGINEERING)
Owner Name: THOMAS M MCDONALD	Business Opened: 09/25/2006
Business Location: 3563 NW 53 ST FT LAUDERDALE	State/County/Cert/Reg: 0507-001228
Business Phone: 954-739-6400	Exemption Code:

Rooms	Seats	Employees 5	Machines	Professionals
-------	-------	----------------	----------	---------------

Number of Machines:				Vending Type:			
Tax Amount	Transfer Fee	NSF Fee	Penalty	Prior Years	Collection Cost	Total Paid	
30.00	0.00	0.00	0.00	0.00	0.00	30.00	

THIS RECEIPT MUST BE POSTED CONSPICUOUSLY IN YOUR PLACE OF BUSINESS

THIS BECOMES A TAX RECEIPT WHEN VALIDATED

This tax is levied for the privilege of doing business within Broward County and is non-regulatory in nature. You must meet all County and/or Municipality planning and zoning requirements. This Business Tax Receipt must be transferred when the business is sold, business name has changed or you have moved the business location. This receipt does not indicate that the business is legal or that it is in compliance with State or local laws and regulations.

<p>Mailing Address: THOMAS M MCDONALD 3563 NW 53 ST FORT LAUDERDALE, FL 33309</p>	<p>Receipt # 1CP-15-00010932 Paid 07/12/2016 30.00</p>
--	--

2016 - 2017