

LLM – Live Line Monitor

Overview:

M-Tronix is your source for highly innovative electronic control, protection, and monitoring systems for mining and general industry. M-Tronix is your exclusive distributor of the Bramco product range.

Application:

The Bramco M-Tronix Live Line Monitor provides a remote visual display of the status of each phase of a 3 phase AC load circuit.

Features:

The LLM Module is a compact, DIN or screw mounted, low power, three phase input device to provide visual indication of load phases being present.

The three load phases and Earth are connected to the LLM module.

The Remote Display Indicator is mounted on the door panel and connects to terminals on the LLM Module.

Normal:

- No AC -three phase LEDs should be Off.
- AC On -the three phase LEDs will be On.
- If any or all the LEDs are On, the circuit is alive.

Fault:

- If any or all of the three phase LEDs are On, indicates a load phase not isolated.

LEDs for:

- Phase AU
- Phase B V
- Phase C W

Note: Dual LEDs for each phase.

Ordering Information:

A00971 - LLM module 660-1100V

A01247 - LLM module 375 -635vAC

A00739 - LLM remote display

Specifications:

System Voltage: (See models)

- 660 -1100vAC 50/60Hz
- 375 -635vAC

AC Voltage: 1000vAC 1 minute (PH to E)

Phase Loading to Earth: 100k Ohms at 50Hz

DC Voltage: 2000vDC 1 minute (Ph to E)

Phase Loading to Earth: 20M Ohms at DC.

- Local/Remote Display have dual LEDs for each phase.
- Remote Display Touch Potential - 24vDC maximum when earth is connected

Operating Temperature: 0 - 50°C

Enclosure LLM Module:

Dimensions: 75mmW x 55mmH x 110mmD

Material:

- High impact resistant polycarbonate construction
- IP20 Rating

Mounting: DIN rail

Terminals: Cage screw terminals

Weight: 300gms

Enclosure Remote Display:

- Panel cut-out 22.5mm diameter
- Bezel 30mm diameter x 20mm projection
- Depth 50mm excluding 4 wires
- Connection through 2m x 4 cores cable
- Weighs 100gms

Compliance:

ANZEx 11.3014X

This product is designed and manufactured in accordance with ISO9001:2000 requirements.

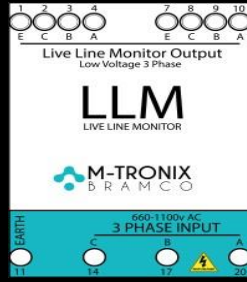

LLM – Live Line Monitor

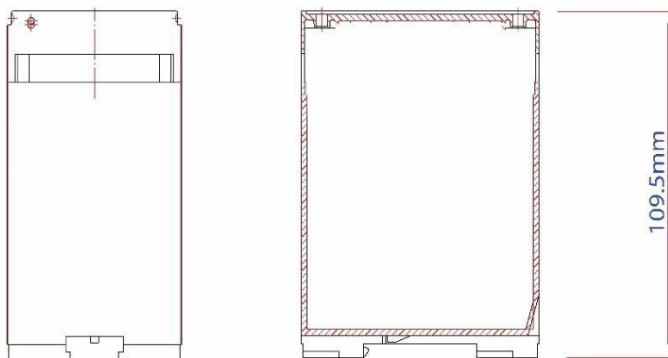
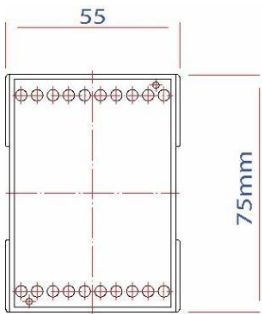
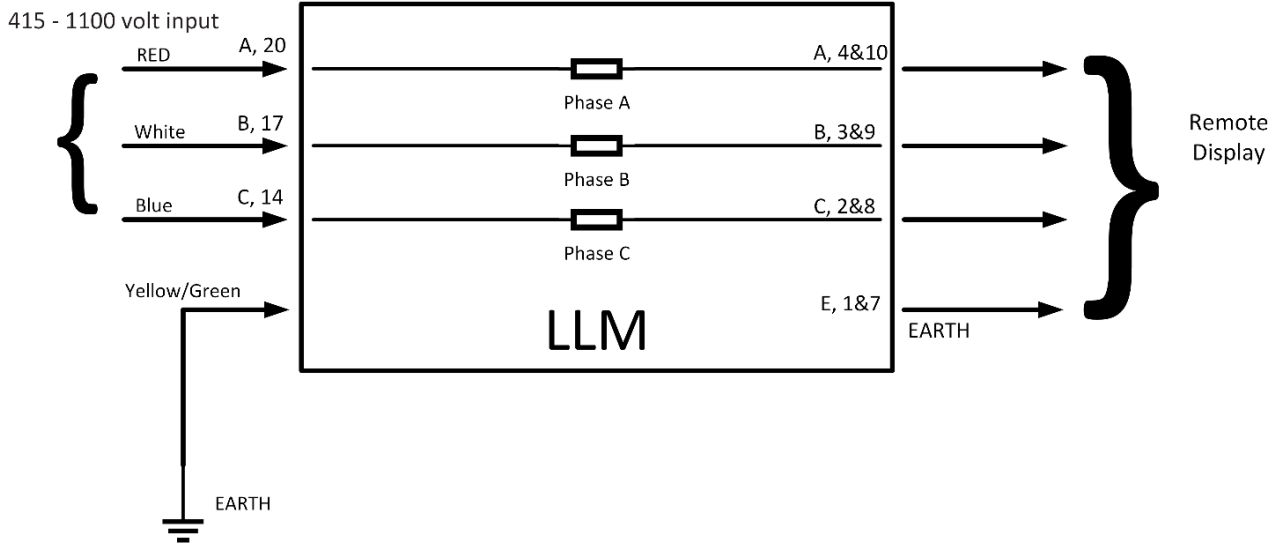

M-TRONIX Contacts
 Telephone +61 435 939 513
 Email: info@m-tronix.com.au
www.m-tronix.com.au

Compliance:
 AS/NZS 2081:2011
 The bar3 comes with a 2-year warranty.