

# Flushing Map

## SPRING 2024 FLUSHING SCHEDULE

## WATER MAIN FLUSHING

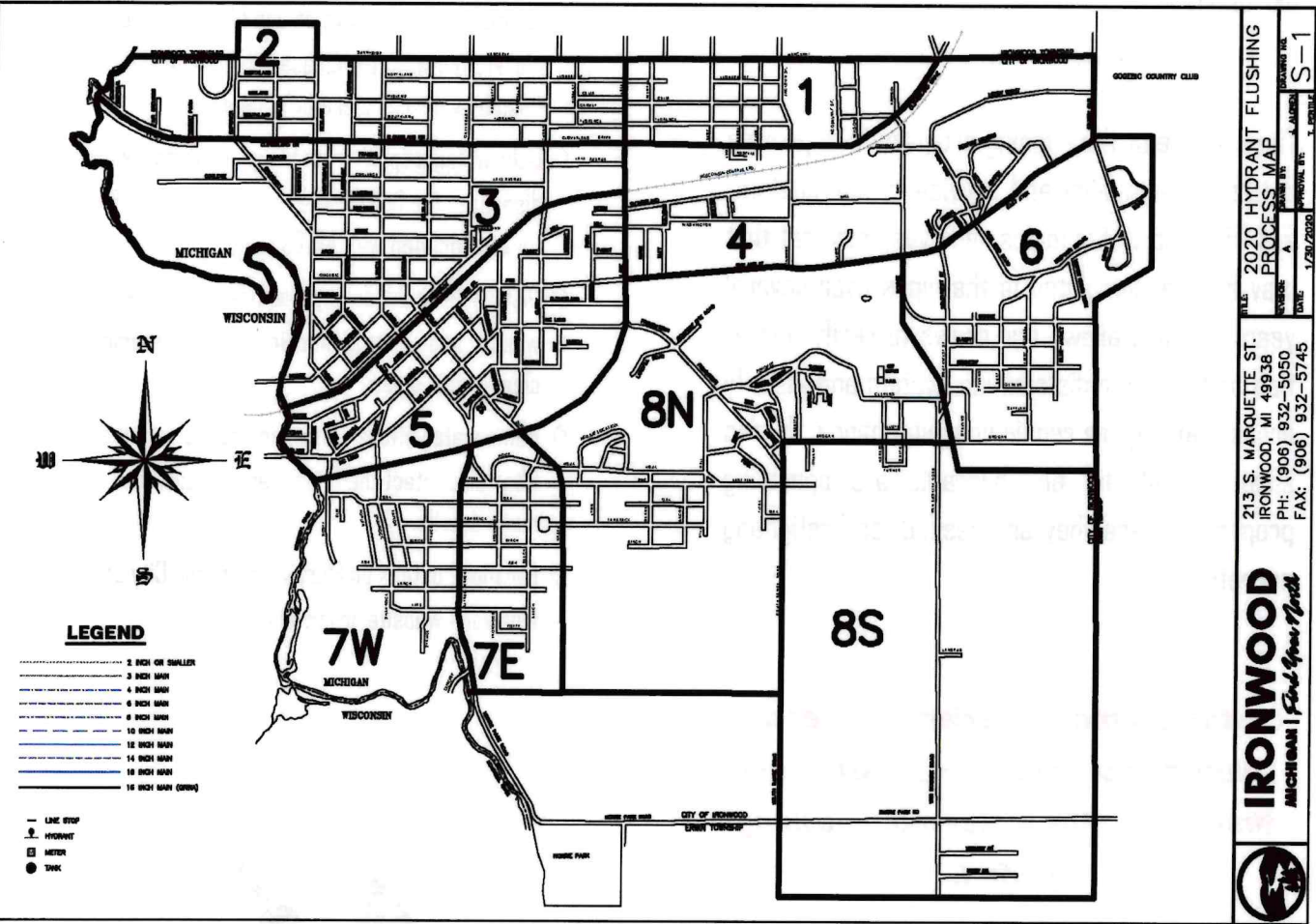

Area 1 – May 5 to 6	Area 5 & 6 – May 8 to 9
Area 2 – May 6 to 7	Area 7E & 7W - May 9 to 10
Area 3 & 4 – May 7 to 8	Area 8N & 8S -May 9 to 10

*Customers may experience water discoloration or change in pressure any time during the water main flushing period.*

WATER UTILITY DEPARTMENT  
213 S. MARQUETTE ST.  
IRONWOOD, MI 49938  
906-932-5050  
Ext. 111 & 112

## SPRING 2024 FLUSHING SCHEDULE

## Flushing your home plumbing system

- ◇ Take a water meter reading before and after running your **cold** water and give readings and your address to the water department for a credit on your utility bill.
- ◇ Flush ALL cold water taps until clear.
- ◇ Avoid using hot water until cold water runs clear.
- ◇ Flush ALL appliances such as Ice Makers, Dishwashers, Washing Machines, Water Filters and Softeners etc..
- ◇ After flushing your water, filters may need to be replaced, if located at point of entry.
- ◇ For more details on Flushing go to the City of Ironwood website: [ironwoodmi.gov](http://ironwoodmi.gov)

Bottled water is available for City of Ironwood residents in the lobby of the Ironwood Public Safety Building at 123 West McLeod Ave. ( 1 Case per family )

\*\*\*\*\*

The purpose of the flushing program is to provide better water quality and service to our customers. Flushing water mains removes sediment that may have accumulated in the pipes over several years. It also allows our crews to verify operation of the water distribution system and identify areas that require repair or maintenance. It also ensures that the fire hydrants are operating properly in case they are needed for firefighting operations.

***Customers may experience water discoloration or change in pressure any time during the water main flushing period.***

## Flushing your Appliances

- ◇ Ice makers-If you have or use filters on your ice maker, you want to replace the filter AFTER flushing your refrigerator's ice maker.
- ◇ Cold-water dispenser on fridge-flush cold water dispenser for five minutes and replace any filters associated with AFTER flushing.
- ◇ Dishwashers & Washing Machines-run dishwasher and washing machine empty one time to clear water pipes.
- ◇ Home water filters- clean or change your water filter or contact the filter manufacturer for more details.
- ◇ For more details on Flushing go to the City of Ironwood website: [ironwoodmi.gov](http://ironwoodmi.gov)



## Flushing your home plumbing system

- ◇ Take a water meter reading before and after running your **cold** water and give readings and your address to the water department for a credit on your utility bill.
- ◇ Flush ALL cold water taps until clear.
- ◇ Avoid using hot water until cold water runs clear.
- ◇ Flush ALL appliances such as Ice Makers, Dishwashers, Washing Machines, Water Filters and Softeners etc..
- ◇ After flushing your water, filters may need to be replaced, if located at point of entry.
- ◇ For more details on Flushing go to the City of Ironwood website: [ironwoodmi.gov](http://ironwoodmi.gov)

Bottled water is available for City of Ironwood residents in the lobby of the Ironwood Public Safety Building at 123 West McLeod Ave. ( 1 Case per family )

\*\*\*\*\*

The purpose of the flushing program is to provide better water quality and service to our customers. Flushing water mains removes sediment that may have accumulated in the pipes over several years. It also allows our crews to verify operation of the water distribution system and identify areas that require repair or maintenance. It also ensures that the fire hydrants are operating properly in case they are needed for firefighting operations.

***Customers may experience water discoloration or change in pressure any time during the water main flushing period.***

## Flushing your Appliances

- ◇ Ice makers-If you have or use filters on your ice maker, you want to replace the filter AFTER flushing your refrigerator's ice maker.
- ◇ Cold-water dispenser on fridge-flush cold water dispenser for five minutes and replace any filters associated with AFTER flushing.
- ◇ Dishwashers & Washing Machines-run dishwasher and washing machine empty one time to clear water pipes.
- ◇ Home water filters- clean or change your water filter or contact the filter manufacturer for more details.
- ◇ For more details on Flushing go to the City of Ironwood website: [ironwoodmi.gov](http://ironwoodmi.gov)



# Flushing Map

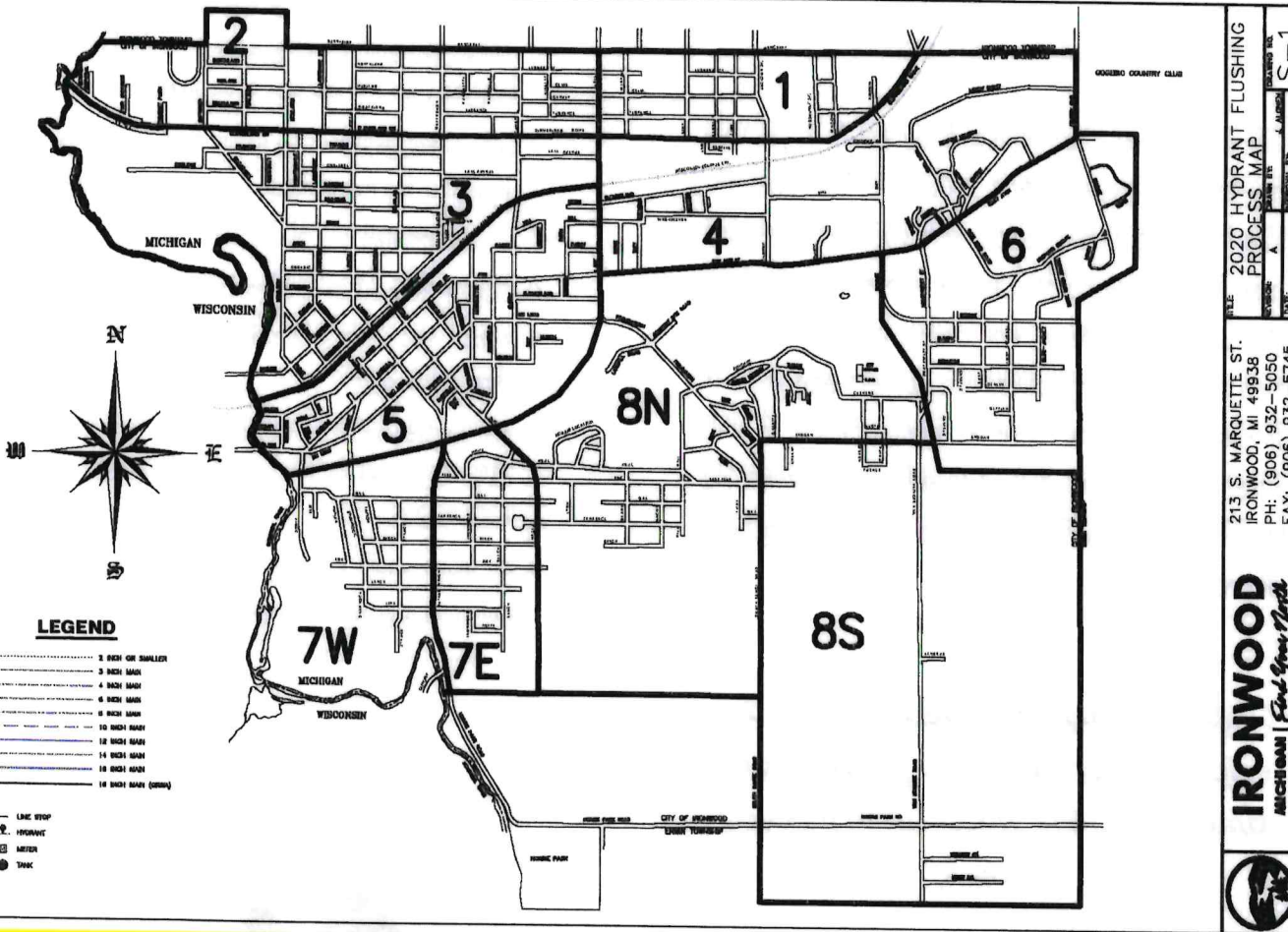

Area 1 – May 5 to 6	Area 5 & 6 – May 8 to 9
Area 2 – May 6 to 7	Area 7E & 7W - May 9 to 10
Area 3 & 4 – May 7 to 8	Area 8N & 8S -May 9 to 10

*Customers may experience water discoloration or change in pressure any time during the water main flushing period.*

## SPRING 2024 FLUSHING SCHEDULE

## SPRING 2024 FLUSHING

### SCHEDULE

# WATER MAIN FLUSHING



**IRONWOOD**  
MICHIGAN | *Find Your North*

WATER UTILITY DEPARTMENT

213 S. MARQUETTE ST.

IRONWOOD, MI 49938

906-932-5050

Ext. 111 & 112